

Pioneer *sound.vision.soul*

DVD/CD Receiver

XV-HTD330

Speaker System

S-HTD330



Operating Instructions



IMPORTANT



The lightning flash with arrowhead symbol, within an equilateral triangle, is intended to alert the user to the presence of uninsulated "dangerous voltage" within the product's enclosure that may be of sufficient magnitude to constitute a risk of electric shock to persons.



CAUTION:
TO PREVENT THE RISK OF ELECTRIC SHOCK, DO NOT REMOVE COVER (OR BACK). NO USER-SERVICEABLE PARTS INSIDE. REFER SERVICING TO QUALIFIED SERVICE PERSONNEL.



The exclamation point within an equilateral triangle is intended to alert the user to the presence of important operating and maintenance (servicing) instructions in the literature accompanying the appliance.

H002_En

IMPORTANT SAFETY INSTRUCTIONS

READ INSTRUCTIONS — All the safety and operating instructions should be read before the product is operated.

RETAIN INSTRUCTIONS — The safety and operating instructions should be retained for future reference.

HEED WARNINGS — All warnings on the product and in the operating instructions should be adhered to.

FOLLOW INSTRUCTIONS — All operating and use instructions should be followed.

CLEANING — Unplug this product from the wall outlet before cleaning. The product should be cleaned only with a polishing cloth or a soft dry cloth. Never clean with furniture wax, benzene, insecticides or other volatile liquids since they may corrode the cabinet.

ATTACHMENTS — Do not use attachments not recommended by the product manufacturer as they may cause hazards.

WATER AND MOISTURE — Do not use this product near water — for example, near a bathtub, wash bowl, kitchen sink, or laundry tub; in a wet basement; or near a swimming pool; and the like.

ACCESSORIES — Do not place this product on an unstable cart, stand, tripod, bracket, or table. The product may fall, causing serious injury to a child or adult, and serious damage to the product. Use only with a cart, stand, tripod, bracket, or table recommended by the manufacturer, or sold with the product. Any mounting of the product should follow the manufacturer's instructions, and should use a mounting accessory recommended by the manufacturer.

CART — A product and cart combination should be moved with care. Quick stops, excessive force, and uneven surfaces may cause the product and cart combination to overturn.



VENTILATION — Slots and openings in the cabinet are provided for ventilation and to ensure reliable operation of the product and to protect it from overheating, and these openings must not be blocked or covered. The openings should never be blocked by placing the product on a bed, sofa, rug, or other similar surface. This product should not be placed in a built-in installation such as a bookcase or rack unless proper ventilation is provided or the manufacturer's instructions have been adhered to.

POWER SOURCES — This product should be operated only from the type of power source indicated on the marking label. If you are not sure of the type of power supply to your home, consult your product dealer or local power company.

LOCATION — The appliance should be installed in a stable location.

NONUSE PERIODS — The power cord of the appliance should be unplugged from the outlet when left unused for a long period of time.

GROUNDING OR POLARIZATION

- If this product is equipped with a polarized alternating current line plug (a plug having one blade wider than the other), it will fit into the outlet only one way. This is a safety feature. If you are unable to insert the plug fully into the outlet, try reversing the plug. If the plug should still fail to fit, contact your electrician to replace your obsolete outlet. Do not defeat the safety purpose of the polarized plug.
- If this product is equipped with a three-wire grounding type plug, a plug having a third (grounding) pin, it will only fit into a grounding type power outlet. This is a safety feature. If you are unable to insert the plug into the outlet, contact your electrician to replace your obsolete outlet. Do not defeat the safety purpose of the grounding type plug.

POWER-CORD PROTECTION — Power-supply cords should be routed so that they are not likely to be walked on or pinched by items placed upon or against them, paying particular attention to cords at plugs, convenience receptacles, and the point where they exit from the product.

OUTDOOR ANTENNA GROUNDING — If an outside antenna or cable system is connected to the product, be sure the antenna or cable system is grounded so as to provide some protection against voltage surges and built-up static charges. Article 810 of the National Electrical Code, ANSI/NFPA 70, provides information with regard to proper grounding of the mast and supporting structure, grounding of the lead-in wire to an antenna discharge unit, size of grounding conductors, location of antenna-discharge unit, connection to grounding electrodes, and requirements for the grounding electrode. See Figure A.

LIGHTNING — For added protection for this product during a lightning storm, or when it is left unattended and unused for long periods of time, unplug it from the wall outlet and disconnect the antenna or cable system. This will prevent damage to the product due to lightning and power-line surges.

POWER LINES — An outside antenna system should not be located in the vicinity of overhead power lines or other electric light or power circuits, or where it can fall into such power lines or circuits. When installing an outside antenna system, extreme care should be taken to keep from touching such power lines or circuits as contact with them might be fatal.

OVERLOADING — Do not overload wall outlets, extension cords, or integral convenience receptacles as this can result in a risk of fire or electric shock.

OBJECT AND LIQUID ENTRY — Never push objects of any kind into this product through openings as they may touch dangerous voltage points or short-out parts that could result in a fire or electric shock. Never spill liquid of any kind on the product.

SERVICING — Do not attempt to service this product yourself as opening or removing covers may expose you to dangerous voltage or other hazards. Refer all servicing to qualified service personnel.

DAMAGE REQUIRING SERVICE — Unplug this product from the wall outlet and refer servicing to qualified service personnel under the following conditions:

- When the power-supply cord or plug is damaged.
- If liquid has been spilled, or objects have fallen into the product.
- If the product has been exposed to rain or water.
- If the product does not operate normally by following the operating instructions. Adjust only those controls that are covered by the operating instructions as an improper adjustment of other controls may result in damage and will often require extensive work by a qualified technician to restore the product to its normal operation.
- If the product has been dropped or damaged in any way.
- When the product exhibits a distinct change in performance — this indicates a need for service.

REPLACEMENT PARTS — When replacement parts are required, be sure the service technician has used replacement parts specified by the manufacturer or have the same characteristics as the original part. Unauthorized substitutions may result in fire, electric shock, or other hazards.

SAFETY CHECK — Upon completion of any service or repairs to this product, ask the service technician to perform safety checks to determine that the product is in proper operating condition.

WALL OR CEILING MOUNTING — The product should not be mounted to a wall or ceiling.

HEAT — The product should be situated away from heat sources such as radiators, heat registers, stoves, or other products (including amplifiers) that produce heat.

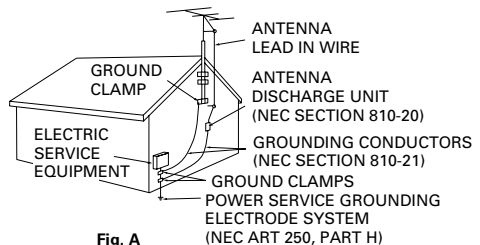

Fig. A

NEC — NATIONAL ELECTRICAL CODE

WARNING: TO PREVENT FIRE OR SHOCK HAZARD, DO NOT EXPOSE THIS APPLIANCE TO RAIN OR MOISTURE.

H001_En

**[For U.S. model]
IMPORTANT NOTICE**

The serial number for this equipment is located on the rear panel. Please write this serial number on your enclosed warranty card and keep it in a secure area. This is for your security.

H006A_En

NOTE: This equipment has been tested and found to comply with the limits for a Class B digital device, pursuant to Part 15 of the FCC Rules. These limits are designed to provide reasonable protection against harmful interference in a residential installation. This equipment generates, uses, and can radiate radio frequency energy and, if not installed and used in accordance with the instructions, may cause harmful interference to radio communications. However, there is no guarantee that interference will not occur in a particular installation. If this equipment does cause harmful interference to radio or television reception, which can be determined by turning the equipment off and on, the user is encouraged to try to correct the interference by one or more of the following measures:

- Reorient or relocate the receiving antenna.
- Increase the separation between the equipment and receiver.
- Connect the equipment into an outlet on a circuit different from that to which the receiver is connected.
- Consult the dealer or an experienced radio/TV technician for help.

H010_En

Information to User

Alteration or modifications carried out without appropriate authorization may invalidate the user's right to operate the equipment. H011_En

CAUTION

- Use of controls or adjustments or performance of procedures other than those specified herein may result in hazardous radiation exposure.
- The use of optical instruments with this product will increase eye hazard.

H013_En

This product includes FontAvenue® fonts licenced by NEC corporation. FontAvenue is a registered trademark of NEC Corporation.

WARNING:

Handling the power cord on this product or cords associated with accessories sold with the product will expose you to lead, a chemical known to the State of California and other governmental entities to cause cancer and birth defects or other reproductive harm.

Wash hands after handling.

[For Canadian model]

CAUTION: TO PREVENT ELECTRIC SHOCK, DO NOT USE THIS (POLARIZED) PLUG WITH AN EXTENSION CORD, RECEPTACLE OR OTHER OUTLET UNLESS THE BLADES CAN BE FULLY INSERTED TO PREVENT BLADE EXPOSURE.

ATTENTION: POUR PREVENIR LES CHOCS ELECTRIQUES NE PAS UTILISER CETTE FICHE POLARISEE AVEC UN PROLONGATEUR UNE PRISE DE COURANT OU UNE AUTRE SORTIE DE COURANT, SAUF SI LES LAMES PEUVENT ETRE INSEREES A FOND SANS EN LAISSER AUCUNE PARTIE A DECOUVERT.

H007A_2L

[For Canadian model]

This Class B digital apparatus complies with Canadian ICES-003.

[Pour le modèle Canadien]

Cet appareil numérique de la classe B est conforme à la norme NMB-003 du Canada.

H009_2L

[For U.S. model]



ENERGY STAR® and the ENERGY STAR certification mark are registered US marks.

K001C_En

Energy-saving design

This system is designed to use 0.39W of electricity when power is switched to standby.

This product is for general household purposes. Any failure due to use for other than household purposes (such as long-term use for business purposes in a restaurant or use in a car or ship) and which requires repair will be charged for even during the warranty period.

K041_En

This product incorporates copyright protection technology that is protected by method claims of certain U.S. patents and other intellectual property rights owned by Macrovision Corporation and other rights owners. Use of this copyright protection technology must be authorized by Macrovision Corporation, and is intended for home and other limited viewing uses only unless otherwise authorized by Macrovision Corporation. Reverse engineering or disassembly is prohibited.

Thank you for buying this Pioneer product.

Please read through these operating instructions so that you will know how to operate your model properly. After you have finished reading the instructions, put them in a safe place for future reference.

Contents

01 Before you start

Features	8
What's in the box	9
Putting the batteries in the remote control	9
Using the remote control	9
Disc / content format playback compatibility	10
General disc compatibility	10
CD-R/RW compatibility	10
DVD-R/RW compatibility	10
PC-created disc compatibility	11
About WMA	11
Compressed audio compatibility	11
JPEG file compatibility	12

02 Connecting up

Connecting the speakers	13
Placing the speakers	14
Wall-mounting the center and surround speaker system	15
Connecting to your TV	16
Connecting using the S-video output	16
Connecting using the component video output	17
Listening to TV audio through this system	17
Connecting the supplied antennas	18
Assembling the loop antenna	18
AM loop antenna	18
FM wire antenna	19
Connecting the power	19

03 Controls and displays

Front panel	20
Display	21
Remote control	23

04 Getting started

Switching on and setting up	26
Setting the clock	27
Using the Room Setup	27
Using the on-screen displays	28
Playing discs	29
Basic playback controls	30
Resume and Last Memory	31
Changing discs	32
DVD-Video disc menus	33
Video CD PBC menus	34
Listening to the radio	34
Improving poor FM reception	35
Memorizing stations	35
Listening to station presets	35
Listening to other sources	36

05 Home theater sound

Auto listening mode	37
Listening in surround sound	37
Dolby Pro Logic II Music settings	38
Listening in stereo	38
Listening with headphones	38
Using the Advanced Surround effects	39
Adjusting the Advanced Surround effect level	39

Enhancing dialogue	40
Listening with a virtual surround back speaker	40
Using Quiet and Midnight listening modes	40
Adjusting the bass and treble.	41
Boosting the bass level	41
Muting the sound.	41

06 Playing audio and video discs

Introduction	42
Playing only CDs, MP3 and WMA discs (CD mode)	42
Using the Disc Navigator to browse the contents of a disc.	42
Scanning discs	44
Playing in slow motion.	44
Frame advance/frame reverse	44
Looping a section of a disc.	45
Using repeat play	45
Using random play.	46
Creating and editing a DVD program list	47
Creating and editing a non-DVD program list	49
Other functions available from the program menu.	50
Searching a disc	51
Switching DVD audio language	51
Switching subtitles.	52
Switching audio channel when playing a Video CD	52
Zooming the screen	52
Switching camera angles.	53
Displaying disc information	53
Front panel display information	54

07 Viewing JPEG discs

Playing a JPEG slideshow	55
Using the JPEG Disc Navigator and Photo Browser	55
Zooming the screen	56

08 Using the timer

Setting the wake-up timer	58
Turning the wake-up timer on/off	59
Setting the sleep timer	59

09 Surround sound setup

Setting up surround sound	61
System Setup menu options	61
Setting the channel levels.	62

10 Video Adjust menu

Video Adjust	64
Creating your own presets.	64

11 Initial Settings menu

Using the Initial Settings menu	66
Video Output settings	66
TV Screen	66
Component Out	67
S-Video Out	68
Language settings.	68
Audio Language	68
Subtitle Language.	68
DVD Menu Language	69
Subtitle Display.	69
Display settings.	69
OSD Language	69
On Screen Display	69
Angle Indicator	70
Options	70
Parental Lock	70
PhotoViewer	72

12 Additional information

Switching off the demo	73
Child Lock	73
Changing the clock format	73
Changing the frequency step.	73
Resetting the system.	74

Using and taking care of discs	74	Troubleshooting	79
Titles, chapters and tracks	74	General	79
DVD Video regions	74	DVD/CD/Video CD player	80
Handling discs	74	WMA/MP3/JPEG discs	81
Storing discs	75	Tuner	81
Discs to avoid	75	Error Messages	82
Proper installation and maintenance of this system	75	Screen sizes and disc formats	83
Hints on installation	75	Widescreen TV users	83
Cleaning the pickup lens	76	Standard TV users	83
Problems with condensation	76	Selecting languages using the language code list	83
Moving the system unit	76	Language code list	84
Power cable caution	76	Country code list	84
Connecting external antennas	77	Glossary	85
Connecting auxiliary components	77	Specifications	87
Reducing the TV and line signal levels . .	78		
Recording mode	78		

Chapter 1

Before you start

Features

24-bit/96kHz compatible DAC

This system is fully compatible with high sampling-rate discs, capable of delivering better-than-CD sound quality in terms of dynamic range, low-level resolution and high-frequency detail.

Dolby Digital, Dolby Pro Logic II*¹ and DTS*²



Built-in Dolby Digital and DTS decoders let you enjoy true discrete multichannel home theater sound with Dolby Digital and DTS encoded DVD discs.

Dolby Pro Logic and Dolby Pro Logic II decoding adds excitement to two-channel source material with surround sound playback.

PureCinema progressive scan

When connected to a progressive scan-compatible TV or monitor using the component video outputs, you can enjoy extremely stable, flicker free images, with the same frame refresh rate as the original movie.

Picture zoom

While a DVD or Video CD is playing, you can zoom in on any part of the picture at up to 4x magnification for a closer look. See *Zooming the screen* on page 52.

MP3 and WMA compatibility

This system is compatible with CD-R, CD-RW and CD-ROM discs that contain MP3 or WMA audio tracks. See also *Compressed audio compatibility* on page 11.

Graphical on-screen displays

Setting up and using your DVD home theater system is made very easy using the graphical on-screen displays.

*¹ *Manufactured under license from Dolby Laboratories. "Dolby", "Pro Logic" and the double-D symbol are trademarks of Dolby Laboratories.*

*² *"DTS" and "DTS Digital Surround" are registered trademarks of Digital Theater Systems, Inc.*

Before you start

What's in the box

Please confirm that the following accessories are in the main system box when you open it.

- Remote control
- AA/R6P dry cell batteries (x2)
- Video cable (yellow plugs)
- AM loop antenna
- FM wire antenna
- Power cable
- These operating instructions
- Warranty card

Please confirm that the following accessories are in the speaker box when you open it.

- Speaker cables (x6)
- non-skid pads for speakers (1 sheet)

Putting the batteries in the remote control

1 Open the battery compartment cover on the back of the remote control.

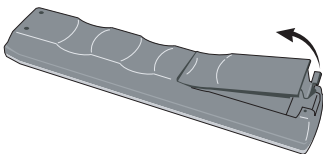

2 Insert two AA/R6P batteries into the battery compartment following the indications (+, -) inside the compartment.

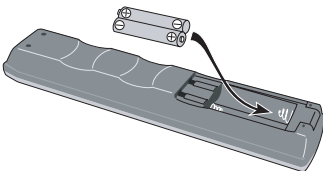

3 Close the cover.

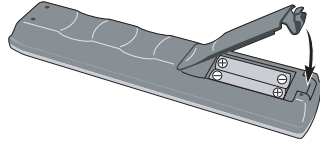

Note

Incorrect use of batteries can result in hazards such as leakage and bursting. Please observe the following:

- Don't mix new and old batteries together.
- Don't use different kinds of battery together—although they may look similar, different batteries may have different voltages.
- Make sure that the plus and minus ends of each battery match the indications in the battery compartment.
- Remove batteries from equipment that isn't going to be used for a month or more.
- When disposing of used batteries, please comply with governmental regulations or environmental public instruction's rules that apply in your country or area.

H048 En

Using the remote control

Keep in mind the following when using the remote control:

- Make sure that there are no obstacles between the remote and the remote sensor on the system unit.
- The remote has a range of about 23 ft. / 7 m at an angle of less than 30°.
- Remote operation may become unreliable if strong sunlight or fluorescent light is shining on the system unit's remote sensor.

- Remote controllers for different devices can interfere with each other. Avoid using remotes for other equipment located close to this system.
- Replace the batteries when you notice a fall off in the operating range of the remote.

Disc / content format playback compatibility

General disc compatibility

This system was designed and engineered to be compatible with software bearing one or more of the following logos:



- Kodak Picture CD
-  is a trademark of Fuji Photo Film Co. Ltd.

Other formats, including but not limited to the following, are not playable in this system:

DVD-Audio / SACD / DVD-RAM DVD-ROM / CD-ROM*

- * Except those that contain MP3, WMA or JPEG. See also Compressed audio compatibility and JPEG file compatibility below.

DVD-R/RW and CD-R/RW discs (Audio CDs and Video CDs) recorded using a DVD recorder, CD recorder or personal computer may not be playable on this system. This may be caused by a number of possibilities, including but not limited to: the type of disc used; the type of recording; damage, dirt or condensation on either the disc or the player's pick-up lens. See below for notes about particular software and formats.

CD-R/RW compatibility

- This system will play CD-R and CD-RW discs recorded in CD Audio or Video CD format, or as a CD-ROM containing MP3, WMA or JPEG files. However, any other content may cause the disc not to play, or create noise/distortion in the output.
- This system cannot record CD-R or CD-RW discs.
- Unfinalized CD-R/RW discs recorded as CD Audio can be played, but the full Table of Contents (playing time, etc.) will not be displayed.

DVD-R/RW compatibility

- This unit will play DVD-R/RW discs recorded using the DVD-Video format that have been finalized using a DVD recorder.
- This unit will play DVD-RW discs recorded using the Video Recording (VR) format.
- **DVD-RW** shows in the display when a VR format DVD-RW disc is loading.
- When playing a VR format DVD-RW discs that was edited on a DVD recorder, the screen may go momentarily black at edited points and/or you may see scenes from immediately before the edited point.
- This system unit cannot record DVD-R/RW discs.
- Unfinalized DVD-R/RW discs cannot be played in this system.

Before you start

PC-created disc compatibility

- If you record a disc using a personal computer, even if it is recorded in a "compatible format" as listed above, there will be cases in which the disc may not be playable in this machine due to the setting of the application software used to create the disc. In these particular instances, check with the software publisher for more detailed information.
- Check the DVD-R/RW or CD-R/RW software disc boxes for additional compatibility information.

About WMA



The Windows Media™ logo printed on the box indicates that this system can playback WMA data.

WMA is short for Windows Media Audio and refers to an audio compression technology developed by Microsoft Corporation. WMA data can be encoded by using Windows Media Player version 8 (or less) or Windows Media Player for Windows XP.

Windows Media, and the Windows logo are trademarks, or registered trademarks of Microsoft Corporation in the United States and/or other countries.

Compressed audio compatibility

- This system unit will play CD-ROM, CD-R, and CD-RW discs containing files saved in the MPEG-1 Audio Layer 3 (MP3) or Windows Media Audio (WMA) format with a sampling rate of 32, 44.1 or 48kHz. Incompatible files will not play and the message **Can't play this format** will be displayed (**NO PLAY** in the front panel display).
- Fixed bit-rate files are recommended. Variable bit-rate (VBR) MP3 files are playable, but playing time may not be shown correctly.
- This system is compatible with WMA data encoded using Windows Media Player version 8 (or less) or Windows Media Player for Windows XP.
- This system is not compatible with lossless-encoding or variable bit-rate (VBR) WMA files.
- WMA files encoded with DRM (Digital Rights Management) copy protection will not play and the message **Can't play this format** will be displayed (**NO PLAY** in the front panel display).
- The CD-ROM used to compile your MP3, WMA must be ISO 9660 Level 1 or 2 compliant. CD physical format: Mode1, Mode2 XA Form1. Romeo and Joliet file systems are both compatible with this system.
- Use CD-R or CD-RW media for recording your files. The disc must be finalized (i.e. the session must be closed) in order to play in this system unit. This system is not compatible with multi-session discs. Only the first session of a multi-session disc will be recognized.
- This system only plays tracks that are named with the file extension .mp3, .MP3, .wma, or .WMA.

- When naming MP3 and WMA files, add the corresponding file name extension (.mp3 or .wma). Files are played according to the file extension. To prevent noise and malfunctions, do not use these extensions for other kinds of files.
- This system can recognize up to 999 files (WMA/MP3) and up to 499 folders. If a disc exceeds these limits, only files and folders up to these limits will be playable. Files and folders are read/displayed in alphabetical order. Note that if the file structure is very complex, you may not be able to read/play all the files on the disc.
- Folder and track names (excluding the file extension) are displayed.
- There are many different recording bit-rates available to encode MP3 files. This system unit was designed to be compatible with all of them. Audio encoded at 128Kbps should sound close to regular CD Audio quality. This system will play lower bit-rate files, but please note that the sound quality becomes noticeably worse at lower bit-rates.

JPEG file compatibility

- Baseline JPEG and EXIF 2.1* still image files up to 8 mega-pixels are supported (maximum vertical and horizontal resolution is 5120 pixels). (**File format used by digital still cameras*)
- The CD-ROM used to compile your JPEG files must be ISO 9660 Level 1 or 2 compliant. CD physical format: Mode1, Mode2 XA Form1. Romeo and Joliet file systems are both compatible with this system.
- This system can recognize up to 999 files (JPEG) and up to 499 folders. If a disc exceeds these limits, only files and folders up to these limits will be playable. Files and folders are read/displayed in alphabetical order. Note that if the file structure is very complex, you may not be able to read/play all the files on the disc.
- Folder and file names (excluding the file extension) are displayed.
- This system only displays files that are named with the file extension .jpg or .JPG.

Chapter 2 Connecting up

Important

- Before making or changing any rear panel connections, make sure that all the components are switched off and unplugged from the power supply.

- **CAUTION:** These speaker terminals can be under **HAZARDOUS VOLTAGE**. When you connect or disconnect the speaker cables, to prevent the risk of electric shock, do not touch uninsulated parts before disconnecting the power cord. (H047 En)

Connecting the speakers

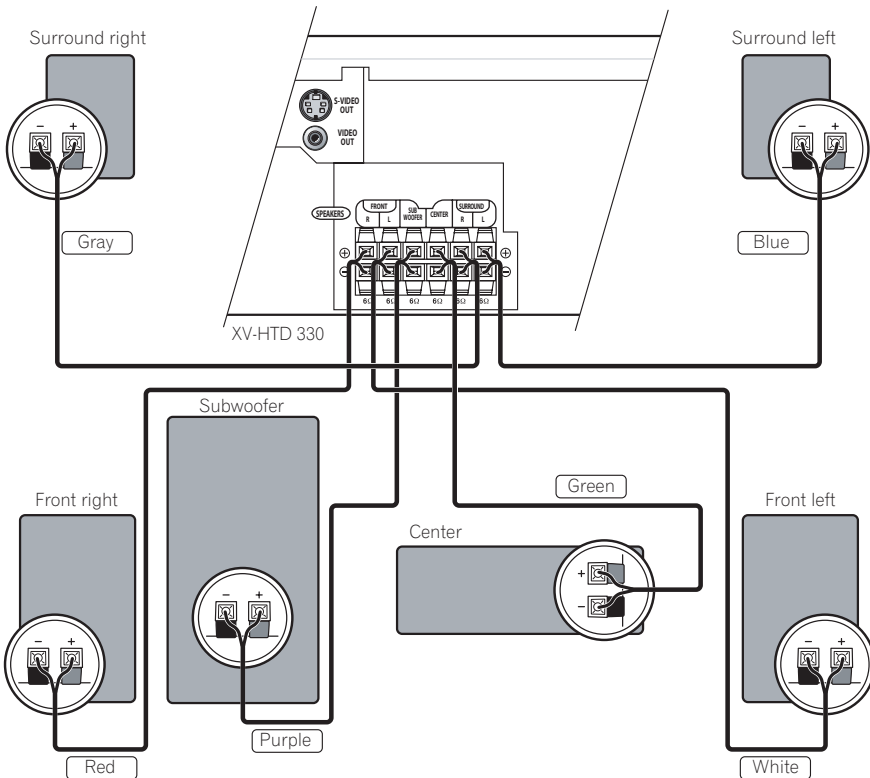

Connect each speaker using the color-coded speaker cable. Match them to the colored labels above the speaker terminals.



Caution

- Do not connect any of the supplied speakers to any other amplifier. This may result in malfunction or fire. This system has been designed for best performance when connected to the supplied speakers. We do not, therefore, recommend that you connect and use other speakers with this system.

1 Twist and pull off the protective shields on each wire.



2 Connect to the speaker terminals on the rear of the system unit.

Match the colored wire with the color-coded label (above the tabs), then insert the colored wire into the red (+) tab and the other wire with the black (-) tab.

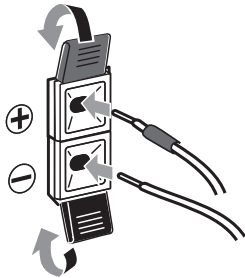

3 Connect to the speaker terminals on the rear of the speakers in the same way.

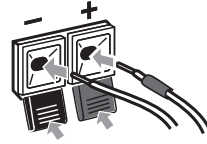

Note

- Remove the supplied non-skid pads from the paper, and stick four onto the base of each satellite speaker. Actual speakers supplied may differ from those shown.

Placing the speakers

Where you put your speakers in the room has a big effect on the quality of the sound. The following guidelines should help you to get the best sound from your system.

- The subwoofer can be placed on the floor. Ideally, the other speakers should be at about ear-level when you're listening to them. Putting the speakers on the floor (except the subwoofer), or mounting them very high on a wall is not recommended.
- For the best stereo effect, place the front speakers 6–9 ft. / 2–3 m apart, at equal distance from the TV.
- Install the center speaker above or below the TV so that the sound of the center channel is localized at the TV screen.
- If possible, install the surround speakers slightly above ear level.

- The illustration below shows typical speaker placement for a surround sound system.

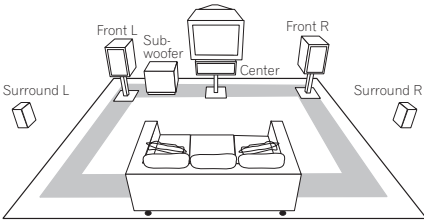

Note

- Make sure that all speakers are securely installed. This not only improves sound quality, but also reduces the risk of damage or injury resulting from speakers being knocked over or falling in the event of external shocks such as earthquakes.
- The front, center and surround speakers supplied with this system are magnetically shielded. However, placing them extremely close to a television may result in color distortion on the screen. If this happens, move the speakers a little further away and switch off the television for 15–30 minutes.
- The subwoofer is not magnetically shielded and so should not be placed near a TV or monitor.

Wall-mounting the center and surround speaker system

Before mounting

- Remember that the speaker system is heavy and that its weight could cause the wood screws to work loose, or the wall material to fail to support it, resulting in the speaker falling. Make sure that the wall you intend to mount the speakers on is strong enough to support them. Do not mount on plywood or soft surface walls.
- Mounting screws are not supplied. Use screws that are suitable for the wall material and that will support the weight of the speaker.

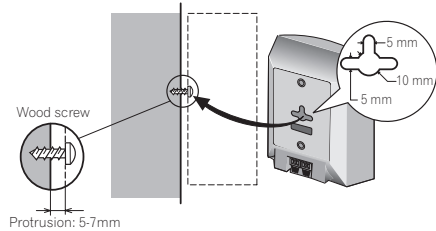

Note

- If you are unsure of the qualities and strength of the walls, consult a professional for advice.
- Pioneer is not responsible for any accidents or damage that result from improper installation.

Connecting to your TV

This system has three different kinds of video output that you can use to connect up your TV. Check the available inputs on your TV to see which you can use.



Important

- Do not connect a VCR between this system and your TV as DVD playback will be affected.
- Use the supplied video cable to connect the VIDEO OUT jack to a video input on your TV.

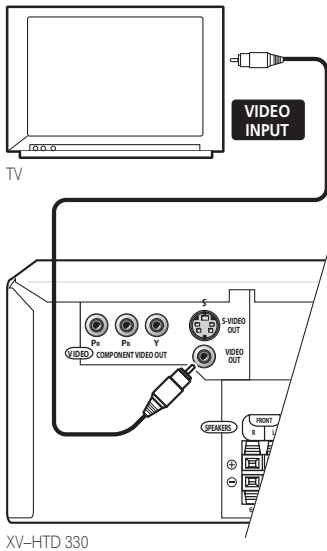

Connecting using the S-video output

If your TV has an S-video input, you can use this instead of the standard video output for a better quality picture.

- Use an S-video cable (not supplied) to connect the S-VIDEO OUT to an S-video input on your TV.

Line up the small triangle above the jack with the same mark on the plug before plugging in.

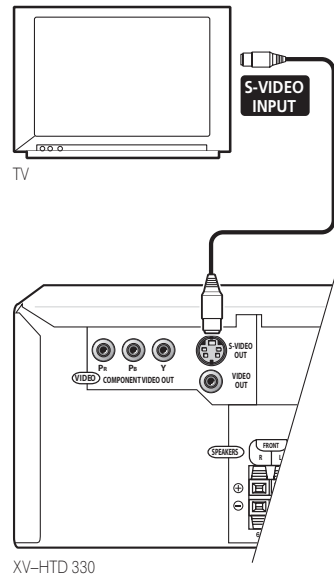

Note

- The S-video output is switchable between S1 and S2 formats for compatibility with all TVs. See *S-Video Out* on page 68 for more on this.

Connecting using the component video output

If your TV has component video inputs, you can use these instead of the standard video output to connect this system to your TV. This should give you the best quality picture from the three types of video output available.

- Use a component video cable (not supplied) to connect the COMPONENT VIDEO OUT to a set of component inputs on your TV.

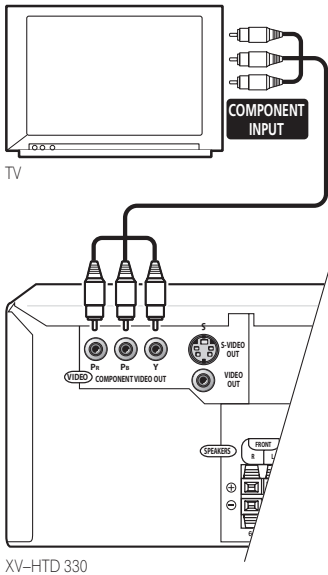

Note

- The component video output is switchable between interlaced and progressive formats. See *Component Out* on page 67 for more on this.

Listening to TV audio through this system

You can connect the audio output of your TV to this system so that broadcast TV sound is played through this system.

- Connect a stereo audio cable (not supplied) from the audio outputs of your TV to the TV IN jacks on this system.

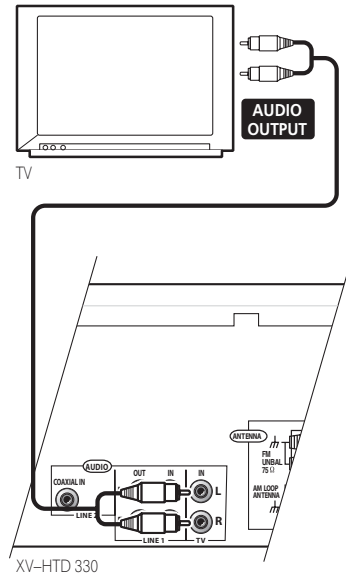

Note

- If you find that the TV audio is distorting when played through this system, you can set the input attenuator to reduce the input signal level. See *Reducing the TV and line signal levels* on page 78.

Connecting the supplied antennas

The supplied antennas provide a simple way to listen to AM and FM radio. If you find that reception quality is poor, an outdoor antenna should give you better sound quality—see *Connecting external antennas* on page 77 for more on how to do this.

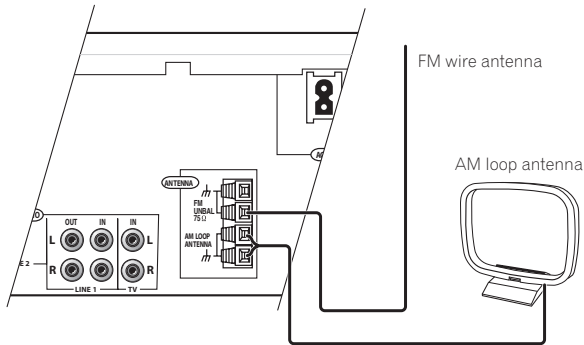

Assembling the loop antenna

- 1 Bend the stand in the direction indicated.

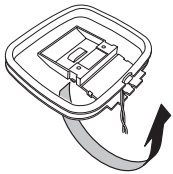

- 2 Clip the loop onto the stand.

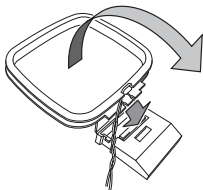

AM loop antenna

- 1 Pull off the protective shields of both AM antenna wires.
- 2 Press the antenna terminal tabs to open and insert one wire into each terminal.
- 3 Release the tabs to secure the AM antenna wires.
- 4 Place the AM antenna on a flat surface and point in the direction giving the best reception.

Avoid placing near computers, television sets or other electrical appliances and do not let it come into contact with metal objects.

 **Note**

- It's also possible to fix the AM antenna to a wall using two screws (see illustration below). Before fixing, make sure that the reception is satisfactory.

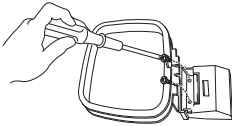

FM wire antenna

- **Connect the FM wire antenna to the FM UNBAL 75Ω terminal in the same way as the AM loop antenna.**

For best results, extend the FM antenna fully and fix to a wall or door frame. Don't drape loosely or leave coiled up.

 **Note**

- The signal ground (⏏) is designed to reduce noise that occurs when an antenna is connected. It is not an electrical safety ground.

Connecting the power

Before connecting the power and switching on for the first time make sure that everything is connected properly.

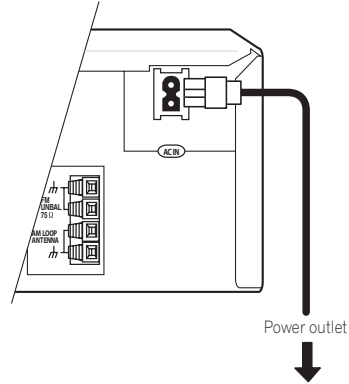

- 1 **Plug one end of the supplied power cable into the AC INLET.**
- 2 **Plug the other end into a household power outlet.**

 **Note**

- See *Connecting auxiliary components* on page 77 for details of other connections you can make with this system.

Chapter 3

Controls and displays

Front panel

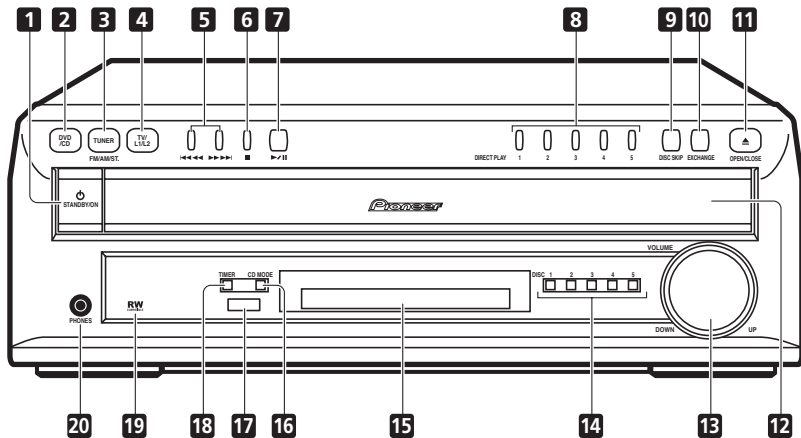

- 1** **⏻ STANDBY/ON** (page 26)
Press to switch the system on or into standby.
- 2** **DVD/CD** (page 29)
Press to switch to the **DVD/CD** function. Also starts/pauses/resumes playback.
- 3** **TUNER FM/AM/ST.** (page 34)
Press to switch to the tuner function, then between bands and station presets.
- 4** **TV/L1/L2** (page 36)
Press to switch between the external sources, **TV**, **LINE 1 (L1)** and **LINE 2 (L2)**.
- 5** **⏮ and ⏭**
Press to skip tracks/chapters; press and hold to scan backwards/forwards.
- When in listening to the tuner, use to tune to stations or select presets.
- 6** **■**
Press to stop playback.
- 7** **▶/⏸**
Press to start or resume playback. During playback, press to pause; press again to restart playback.
- 8** **DIRECT PLAY buttons** (page 30)
Press to start playback of any disc in the player.
- 9** **DISC SKIP** (page 29, 32)
- During playback, press to start playing the next disc in the player.
 - If the disc tray is open while no disc is playing, the tray rotates one disc space.
 - If the disc tray was opened using the **EXCHANGE** button, then pressing **DISC SKIP** rotates the disc tray two disc spaces.

10 EXCHANGE (page 32)

Press during playback to open the disc tray without stopping playback. Press again to close the disc tray.

11 ▲ OPEN/CLOSE

Press to open/close the disc tray.

12 Disc tray

13 VOLUME control

Use to adjust the volume.

14 DISC indicators

Shows which disc spaces are currently occupied.

15 Display

See *Display* on page 21 for detailed information.

16 CD MODE indicator (page 42)

Lights when the CD Mode is on. In this mode, the system only plays audio CDs and WMA/MP3 discs.

17 Remote sensor

18 Timer indicator (page 58)

Lights when the timer is set.

19 RW
COMPATIBLE

This mark indicates compatibility with DVD-RW discs recorded on a DVD recorder in Video Recording (VR) mode.

20 PHONES jack

Headphone jack.

Display

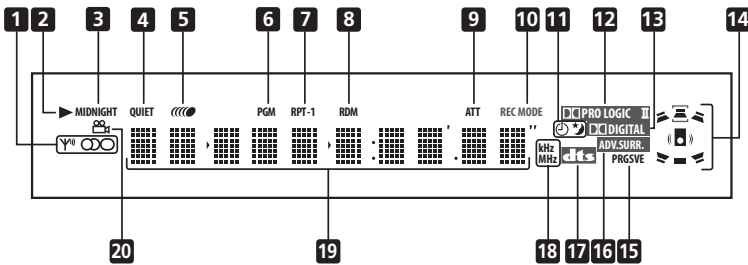

1 Tuner indicators (page 34)



Lights when a broadcast is being received.



Lights when a stereo FM broadcast is being received in auto stereo mode.



Lights when FM mono reception is selected.

2 ▶

Lights when a disc is playing.

3 MIDNIGHT (page 40)

Lights when the Midnight mode is selected.

4 QUIET (page 40)

Lights when the Quiet mode is selected.



Lights to indicate random or repeat play of all discs loaded.

6 PGM (page 47)

Lights when a program list has been programmed.

7 RPT and RPT-1 (page 45)

RPT lights during repeat play. **RPT-1** lights during repeat one-track play.

8 RDM (page 46)

Lights during random play.

9 ATT (page 78)

Lights when the input attenuator is active for the currently selected analog input.

10 REC MODE (page 78)

Lights when Rec Mode is on.

11 Timer indicators (page 58)

Lights when the timer is set



Lights when the sleep timer is active

12 PRO LOGIC II (page 37)

Lights during Dolby Pro Logic decoding.

13 DIGITAL (page 37)

Lights during playback of a Dolby Digital source.

14 Speaker indicators

These show which speakers are being used to output the current source. The illustrations below show some example displays.



5.1 channel surround sound



Stereo (2.1 channel) sound



3.1 channel sound with Dialogue enhancement on the center channel



5.1 channel surround sound with Virtual Surround Back mode active

(When headphones are connected, none of the speaker indicators are lit.)

15 PRGSVE (page 67)

Lights when progressive scan video output is selected.

16 ADV.SURR (page 39)

Lights when one of the Advanced Surround listening modes is selected.

17 DTS (page 37)

Lights during playback of a DTS source.

18 kHz / MHz

Indicates the unit of the frequency shown in the character display (**kHz** for AM, **MHz** for FM)

19 Character display**20**  (page 53)

Lights during multi-angle scenes on a DVD disc

Remote control

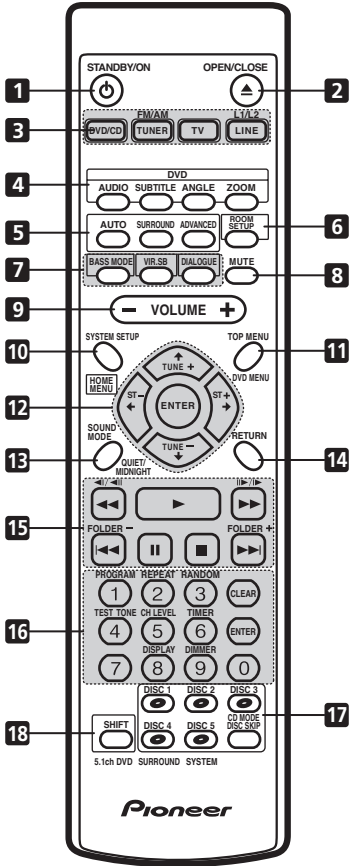

Important

- Functions printed in green on the remote control are accessed using the **SHIFT** button. Press the function button you want while holding down **SHIFT**.

1  **STANDBY/ON** (page 26)
Press to switch the system on or into standby.

2  **OPEN/CLOSE**
Press to open/close the disc tray.

3 **Function select buttons**
Press to select the source you want to listen to (**DVD/CD, TUNER, TV, LINE**)

4 DVD buttons

AUDIO (page 51)
Press to select an audio channel or language.

SUBTITLE (page 52)
Press to display/change the subtitle display.

ANGLE (page 53)
Press to change camera angle during DVD multi-angle scene playback.

ZOOM (page 52)
Press to change the screen zoom level.

5 Surround sound mode buttons

AUTO (page 37)
Press to select the default decoding for the current source.

SURROUND (page 37)
Use to select a Surround mode.

ADVANCED (page 39)
Use to select an Advanced Surround mode.

6 **ROOM SETUP** (page 27)
Press to start Room Setup.

7 Sound enhancement buttons

BASS MODE (page 41)
Use to select a Bass Mode.

VIR. SB (page 40)
Press to switch the Virtual Surround Back speaker effect on/off.

DIALOGUE (page 40)
Use to select a Dialogue mode.

8 MUTE (page 41)

Press to mute all sound from the speakers and headphones (press again to cancel).

9 VOLUME

Use to adjust the volume.

10 HOME MENU / SYSTEM SETUP

- Press to display (or exit) the on-screen menu for Initial Settings, Play Mode functions, etc.
- Use with **SHIFT** for **SYSTEM SETUP**: Use to make various system and surround sound settings. (page 61)

11 DVD MENU / TOP MENU

- Press to display a DVD-Video disc menu, or the Disc Navigator if a VR mode DVD-RW, CD, Video CD, MP3, WMA or JPEG disc is loaded.
- Use with **SHIFT** for **TOP MENU**: Use to display the top menu of a DVD disc in the play position (this may be the same as pressing **DVD MENU**).

12 TUNE +/-, ST +/-, cursor control buttons and ENTER

- Use the **TUNE +/-** and **ST +/-** buttons when listening to the radio to tune into stations, or select preset stations.
- Use the cursor buttons (**↑/↓/←/→**) and enter to navigate on-screen displays and menus; **ENTER** selects an option or executes a command.

13 SOUND MODE / QUIET/MIDNIGHT

- Use to adjust the tone and effect level. (pages 38–41)
- Use with **SHIFT** for **QUIET/MIDNIGHT**: Use to select the Quiet and Midnight modes. (page 40)

14 RETURN

Press to return to a previous menu screen.

15 Playback controls

Press to start or resume playback.



Use for reverse slow motion playback, frame reverse and reverse scanning.



Use for forward slow motion playback, frame advance and forward scanning.



Press to jump to the beginning of the current chapter/track, then to previous chapters/tracks.

Press **SHIFT +** to jump to the beginning of the previous folder



Press to jump to the next chapter/track (or folder by pressing **SHIFT +**).



Press to pause playback; press again to restart.



Press to stop playback.

16 Number buttons and SHIFT functions

Use the number buttons for selecting chapters/tracks from a disc directly; use with the **SHIFT** button to access the functions printed in green.

PROGRAM (SHIFT + 1) (page 47)

Use to program/play a program list.

REPEAT (SHIFT + 2) (page 45)

Use to select a repeat play mode.

RANDOM (SHIFT + 3) (page 46)

Use to select a random play mode.

TEST TONE (SHIFT + 4) (page 62)

Use to output the test tone (for speaker setup).

CH LEVEL (SHIFT + 5) (page 62)

Use to adjust the speaker level.

TIMER (SHIFT + 6) (page 58)

Press to display the clock and to access the timer menu.

DISPLAY (SHIFT + 8) (page 53)

Press to display/change disc information shown on-screen.

DIMMER (SHIFT + 9)

Press to switch between normal and dimmed front panel display.

CLEAR

Press to clear an entry.

ENTER

Press to select menu options, etc. (works exactly the same as the **ENTER** button in **12** above).

17 Disc selection buttons**DISC select buttons** (page 29)

Use to select discs in the player.

DISC SKIP / CD MODE

- During playback, press to start playing the next disc in the player.
- If the disc tray is open while no disc is playing, the tray rotates one disc space.
- If the disc tray was opened using the **EXCHANGE** button (front panel only), then pressing **DISC SKIP** rotates the disc tray two disc spaces. (page 29, 32)
- Use with **SHIFT** for **CD MODE**: Use to switch CD Mode on/off. (page 42)

18 SHIFT

Use to access the functions/commands printed in green on the remote (press the button for the function you want while holding down **SHIFT**).

Chapter 4

Getting started

Switching on and setting up

After making sure everything is connected up properly, you're ready to switch on. The first thing to do is to tell the system what kind of TV you're using, standard or widescreen.

After that you can set up the surround sound for your room, and set the clock so that you can use the timer features.

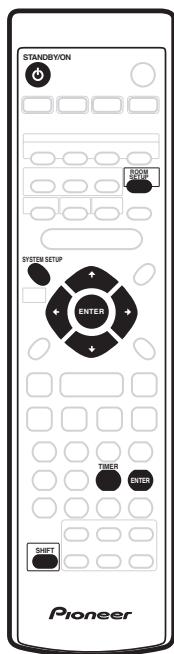

- 1 Press **⏻ STANDBY/ON** (on the remote or on the front panel) to switch the system on.

Also make sure that your TV is switched on and that the video input is set to this system. You should see the welcome screen displayed.

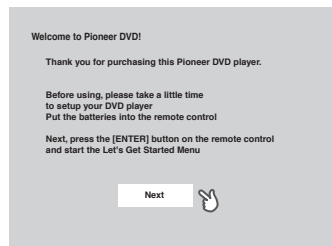

- 2 Press **ENTER** to move on to the next screen.

- 3 Use the **←/→** (cursor left/right) buttons to select either 'Wide screen' or 'Standard size screen' according to the kind of TV you have, then press **ENTER**.

See also *Screen sizes and disc formats* on page 83 if you're not sure which one to choose.

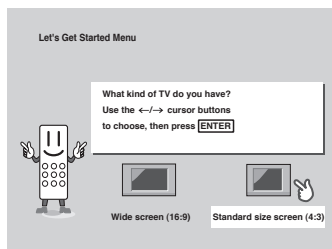

4 Press ENTER again to finish setting up.

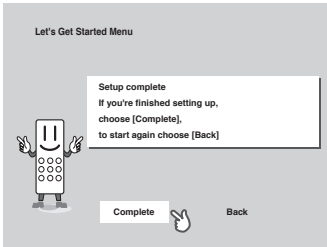

- Use the **→** (cursor right) button to select **BACK** then press **ENTER** if you want to go back and change the setting you just made.



Tip

- You can also use the **▲ OPEN/CLOSE** button on the front panel or the function buttons (**DVD/CD**, **TUNER**, etc.) to switch the system on from standby.



FAQ

- *The system switches on, but there is nothing displayed on my TV.*

Make sure that the TV is set to the correct video input (not a TV channel). For example, if you connected this system to the **VIDEO 1** input on your TV, switch your TV to **VIDEO 1**.

Setting the clock

Setting the clock allows you to use the timer features.

1 Press **TIMER (SHIFT + 6)**.

- If you are adjusting the clock, rather than setting it for the first time, press **TIMER (SHIFT + 6)** again.

2 If **CLOCK ADJ** isn't already shown in the display, press **←** or **→** (cursor left or right) until you see it.

3 Press **ENTER**.

4 Use the **↑/↓** (cursor up/down) buttons to set the hour.

5 Press **ENTER**.

6 Use the **↑/↓** (cursor up/down) buttons to set the minute.

7 Press **ENTER** to confirm.

The display flashes to indicate the clock is set.



Tip

- Press **TIMER (SHIFT + 6)** anytime to display the clock.



Note

- If you unplug the system from the wall outlet, or there is a power outage, you will need to set the clock again.

Using the Room Setup

Before using your DVD system to enjoy surround sound playback, we recommend you spend a few minutes using the Room Setup. This is a quick and easy way to get good surround sound for your room.

Depending on the distance of the surround speakers from your main listening position, choose between **S** (small), **M** (medium), or **L** (large) room, then depending on your seating position relative to the front and surround speakers, choose **Fwd** (forward), **Mid**, or **Back**.

1 If the system isn't already on, press **STANDBY/ON** to switch it on.

2 Press **ROOM SETUP**.

- If you have previously set up the room type and seating position, the display will show the current room settings.

3 Press **ENTER**.

4 Use the **↑/↓** (cursor up/down) buttons to select a room type then press **ENTER**.

Choose one of the following depending on your room size:

- **S** – Smaller than average room
- **M** – Average room
- **L** – Larger than average room

5 Use the **↑/↓** (cursor up/down) buttons to select a seating position setting, then press **ENTER**.

Choose one of the following depending on where your main listening position is:

- **Fwd** – If you are nearer to the front speakers than the surround speakers
- **Mid** – If you are equal distance from the front and surround speakers
- **Back** – If you are nearer to the surround speakers than the front speakers



Note

- The Room Setup automatically sets up channel levels and channel delay. If you have already set the channel levels manually (see *Setting the channel levels* on page 62), you will see **Room Set?** in the display when you first press the **ROOM SETUP** button. If you continue, the previous settings will be overwritten.
- For more detailed surround sound setup, see *Setting up surround sound* on page 61.

Using the on-screen displays

For ease of use, this system makes extensive use of graphical on-screen displays (OSDs). You should get used to the way these work as you'll need to use them when setting up the system, using some of the playback features, such as program play, and when making more advanced settings for audio and video.

All the screens are navigated in basically the same way, using the cursor buttons to change the highlighted item and pressing **ENTER** to select it.

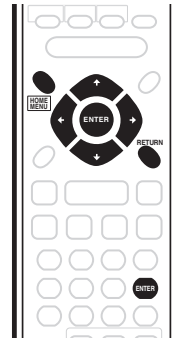

Button	What it does
HOME MENU	Displays/exits the on-screen display
←↑↓→	Changes the highlighted menu item
ENTER	Selects the highlighted menu item (both ENTER buttons work in exactly the same way)
RETURN	Returns to the main menu without saving changes

**Important**

- Throughout this manual, 'Select' means use the cursor buttons to highlight an item on-screen, then press **ENTER**.

**Tip**

- The button guide at the bottom of every OSD screen shows you which buttons you'll need to use for that screen.

Playing discs

The basic playback controls for playing DVD, CD, Video CD and WMA/MP3 discs are covered here. Further functions are detailed in the next chapter.

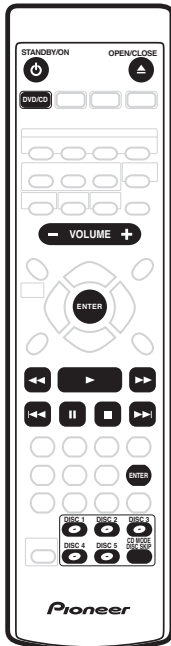

1 If the system isn't already on, press **STANDBY/ON** to switch on.

If you're playing a DVD or Video CD, also turn on your TV and make sure that it is set to the correct video input.

2 Press **OPEN/CLOSE** to open the disc tray.

3 Load a disc.

Load a disc with the label side facing up in the front-most disc space, using the disc tray guide to align the disc. (If you're loading a double-sided DVD disc, load it with the side you want to play face down.)

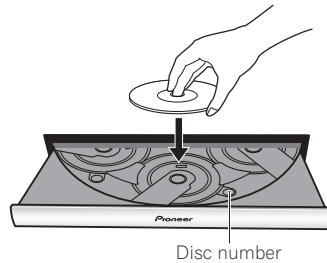

If you want to load more discs, press **DISC SKIP** (remote or front panel) to rotate the disc tray. You can load up to five discs at once.

- Do not place discs in the two partially accessible disc spaces, as it is easy to misalign them. Use only the front-most space.
- Do not load more than one disc in a space.
- Before loading or removing discs, always wait for the disc mechanism to come to a complete stop.
- Do not rotate the disc tray by hand. Always use the **DISC SKIP** button.
- Sometimes, when the disc tray mechanism is moving, the controls are inoperative.

4 Press ► (remote) or ►/II (front panel) to start playback of the disc loaded in the front-most disc space.

Alternatively, use the **DISC** buttons on the remote, or the **DIRECT PLAY** buttons on the front panel to start playback of other discs.

If you're playing a DVD or Video CD, a menu may appear. See *DVD-Video disc menus* on page 33 and *Video CD PBC menus* on page 34 for how to navigate these.

If you're playing an WMA/MP3 or JPEG disc, it may take a few seconds before playback starts, depending on the complexity of the file structure on the disc.

If you loaded a CD/CD-R/RW containing JPEGs, a slideshow will start. See *Viewing JPEG discs* on page 55 for more on playing these discs.

- See also *PhotoViewer* on page 72 if the disc contains both WMA/MP3 audio files and JPEG picture files.





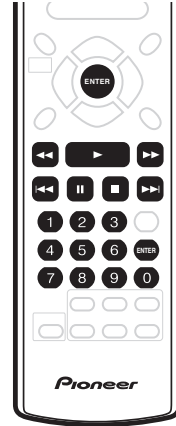

5 Use the – VOLUME + button (or the front panel VOLUME knob) to adjust the volume.

Basic playback controls

The table below shows the basic controls on the remote for playing discs. You can find other playback features in *Playing audio and video discs* on page 42.



Button	What it does
►	Starts playback. <i>DVD and Video CD:</i> If the display shows Resume or Last Mem playback starts from the resume or last memory point (see also <i>Resume and Last Memory</i> below.)
II	Pauses a disc that's playing, or restarts a paused disc.
■	Stops playback. <i>DVD and Video CD:</i> The display shows Resume . Press ■ again if you want to cancel the resume function. (See also <i>Resume and Last Memory</i> below.)



Button	What it does
	Press to start fast reverse scanning. Press  (play) to resume normal playback.
	Press to start fast forward scanning. Press  (play) to resume normal playback.
	Skips to the start of the current track or chapter, then to previous tracks/chapters.
	Skips to the next track or chapter.
FOLDER +/-	Skips to the next/previous folder when playing an WMA/MP3 disc.
Numbers	<ul style="list-style-type: none"> • If the disc is stopped, playback starts from the selected title (for DVD) or track number (for CD/Video CD/WMA/MP3) after a few seconds (or after pressing ENTER). • If the disc is playing, playback jumps to the start of the selected chapter or track after a few seconds (or after pressing ENTER).

**Note**

- You may find with some DVD discs that some playback controls don't work in certain parts of the disc. This is not a malfunction.

Using the front panel controls

The  **OPEN/CLOSE** and  (stop) buttons on the front panel work the same way as the remote control equivalents.

The front panel scan and skip buttons ( and ) are combined. Press once for chapter/track skip, or press and hold for scanning.

Resume and Last Memory

When you stop playback of a DVD or Video CD disc, **Resume** is shown in the display indicating that you can resume playback again from that point.

If the disc tray is not opened, the next time you start playback the display shows **Resume** and playback resumes from the resume point.

For DVD discs only: If you change discs using the **DISC SKIP**, **DISC** or **DIRECT PLAY** buttons, or take the disc out of the player, the play position is stored in memory. When you load the disc next time, the display shows **Last Mem** and you can resume playback (this works for up to five discs).

If you want to clear the resume/last memory point, press  (stop) while **Resume** or **Last Mem** is displayed.

**Note**

- When a Video CD is loaded, the Resume point is lost if the system is switched off.
- For the Last Memory function to work, you must press  (stop) to stop playback before opening the disc tray or changing the disc.
- The Last Memory function doesn't work with VR format DVD-RW discs.

Changing discs

You can change any of the discs not in the play position using the **EXCHANGE** button on the front panel. Because the disc in the play position is unaffected, you can use this button to change discs even during playback.

1 Press **EXCHANGE** to open the disc tray.

- The **EXCHANGE** button only works when there is at least one disc loaded.

2 Load a disc with the label side facing up, using the disc tray guide to align the disc.

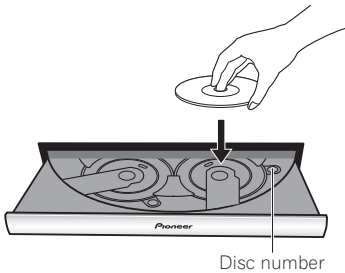

- If you want to load more discs, press **DISC SKIP** to rotate the disc tray two disc spaces.
- Before loading or removing discs, always wait for the disc mechanism to come to a complete stop.
- Load discs only in the two fully accessible disc spaces. Do not try and load discs into any of the other spaces; they may not load correctly and cause the system to malfunction.
- Do not rotate the disc tray by hand. Always use the **DISC SKIP** button.
- Do not obstruct the movement of the disc tray.

3 Press **EXCHANGE** or **▲ OPEN/CLOSE** to close the disc tray.

- Always use the **▲ OPEN/CLOSE** or **EXCHANGE** button to close the disc tray after exchanging discs. Never push the disc tray shut by force.



FAQ

- *After I load a DVD disc, it ejects automatically after a few seconds!*

Most likely, the disc is the wrong region for your system. The region number should be printed on the disc; check it against the region number of the system (which you can find on the rear panel). See also *DVD Video regions* on page 74.

If the region number is OK, it may be that the disc is damaged or dirty. Clean the disc and look for signs of damage. See also *Using and taking care of discs* on page 74.

- *Why won't the disc I loaded play?*

First check that you loaded the disc the right way up (label side up), and that it's clean and not damaged. See *Using and taking care of discs* on page 74 for information on cleaning discs.

If a disc loaded correctly won't play, it's probably an incompatible format or disc type, such as DVD-Audio or DVD-ROM. See *Disc / content format playback compatibility* on page 10 for more on disc compatibility.

- *I have a widescreen TV so why are there black bars at the top and bottom of the screen when I play some discs?*

Some movie formats are such that even when played on a widescreen TV, black bars are necessary at the top and bottom of the screen. This is not a malfunction.

- *I have a standard (4:3) TV and set the system to show widescreen DVDs in pan & scan format, so why do I still get black bars top and bottom with some discs?*

Some discs override the display preferences of the system, so even if you have **4:3 (Pan & Scan)** selected, those discs will still be shown in letterbox format. This is not a malfunction.

DVD-Video disc menus

Many DVD-Video discs contain menus from which you can select what you want to watch. They may give access to additional features, such as subtitle and audio language selection, or special features such as slideshows. See the disc packaging for details.

Sometimes DVD-Video menus are displayed automatically when you start playback; others only appear when you press **DVD MENU** or **TOP MENU**.

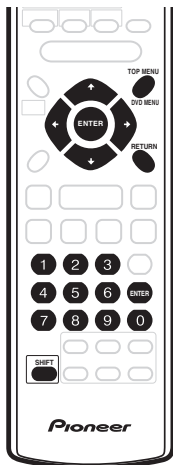

Button	What it does
TOP MENU (SHIFT + DVD MENU)	Displays the 'top menu' of a DVD disc—this varies with the disc.
DVD MENU	Displays a DVD disc menu—this varies with the disc and may be the same as the 'top menu'.
← ↑ ↓ →	Moves the cursor around the screen.
ENTER	Selects the current menu option.
RETURN	Returns to the previously displayed menu screen.
Numbers	Highlights a numbered menu option (some discs only). Press ENTER to select.

Video CD PBC menus

Some Video CDs have menus from which you can choose what you want to watch. These are called PBC (Playback control) menus.

You can play a PBC Video CD without having to navigate the PBC menu by starting playback using a number button to select a track, rather than ► (play) (or ►/|| on the front panel).



Button	What it does
RETURN	Displays the PBC menu.
Numbers	Selects a numbered menu option.
◀◀	Displays the previous menu page (if there is one).
▶▶	Displays the next menu page (if there is one).
ENTER	Press to select highlighted menu option.

Listening to the radio

The tuner can receive both FM and AM broadcasts, and lets you memorize your favorite stations so you don't have to manually tune in every time you want to listen.

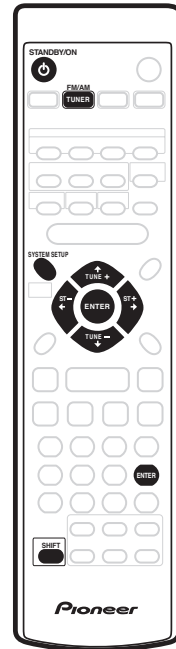

- 1** If the system isn't already on, press **STANDBY/ON** to switch on.
- 2** Press **TUNER** to switch to the tuner, then press repeatedly to select the **AM** or **FM** band.

The display indicates the tuner band and the frequency.

- If you're using the front panel controls, the **TUNER** button switches between FM, AM and station presets (see on page 35).

3 Tune to a frequency.

There are three tuning modes—manual, auto, and high-speed:

- **Manual tuning:** Press **TUNE +/-** repeatedly to change the displayed frequency.
- **Auto tuning:** Press and hold **TUNE +/-** until the frequency display starts to move, then release. The tuner will stop on the next station it finds. Repeat to search for other stations.
- **High-speed tuning:** Press and hold **TUNE +/-** until the frequency display starts to move rapidly. Keep the button held down until you reach the frequency you want. If necessary, fine tune the frequency using the manual tuning method.



Tip

- You can use the **◀◀◀◀** and **▶▶▶▶** buttons on the front panel instead of the **TUNE +/-** buttons.

Improving poor FM reception

If you're listening to an FM station in stereo but the reception is weak, you can improve the sound quality by switching to mono.

1 Press SYSTEM SETUP (SHIFT + HOME MENU).

2 Use the ◀/▶ (cursor left/right) buttons to choose 'FM Mode?', then press ENTER.

3 Use the ↑/↓ (cursor up/down) buttons to select 'Mono' or 'Auto', then press ENTER.

Select **Auto** in step **3** to switch back to auto-stereo mode (the stereo indicator lights when receiving a stereo broadcast).

Memorizing stations

You can save up to 30 station presets so that you always have easy access to your favorite stations without having to tune in manually each time.

1 Tune to an AM or FM radio station.

For the FM band, select mono or auto-stereo reception as necessary. This setting is saved along with the preset.

2 Press SYSTEM SETUP (SHIFT + HOME MENU).

3 Use the ◀/▶ (cursor left/right) buttons to choose 'St. Memory?' then press ENTER.

4 Use the ↑/↓ (cursor up/down) buttons to select the station preset you want.

There are 30 preset locations; each can store one station preset.

5 Press ENTER to save the station preset.



Note

- If the system is unplugged from the power supply completely, saved stations will remain for several days, after which you'll have to save them again.

Listening to station presets

1 Make sure the TUNER function is selected.

2 Use the ST +/- buttons to select a station preset.

- If you are using the front panel controls, press **TUNER FM/AM/ST.** until you're in station preset mode, then use the **◀◀◀◀** and **▶▶▶▶** buttons to select a station preset.

Listening to other sources

You can connect up to three external sources (TV, satellite receiver, etc.) to this system, including one digital source. See also *Listening to TV audio through this system* on page 17 and *Connecting auxiliary components* on page 77.

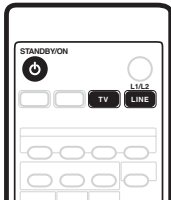

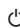
1 If the system isn't already on, press  STANDBY/ON to switch on.

Also make sure that the external source (TV, satellite receiver, etc.) is switched on.

2 Select the source you want to listen to.

- If you're using the remote control, press **TV** to select the **TV** input, or use the **LINE (L1/L2)** button to select the **LINE 1** or **LINE 2** input.
- Using the front panel controls, the **TV/L1/L2** button switches between the three inputs.

3 If necessary, start playback of the external source.

Chapter 5

Home theater sound

Using this system you can enjoy listening to sources, analog or digital, in either stereo or surround sound.

Auto listening mode

The Auto listening mode is the simplest way to listen to any source as it was mastered: the output from the speakers mirrors the channels in the source material.

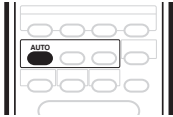

- Press **AUTO** to select the 'Auto' listening mode.

If the source is Dolby Digital or DTS, the **DIGITAL** or **DTS** indicator on the front panel lights.



Note

- Any previously active Dolby Pro Logic or Advanced Surround mode is cancelled when Auto listening mode is selected.

Listening in surround sound

You can listen to any source—stereo or multichannel, analog or digital—in surround sound. Surround sound is generated from stereo sources using one of the Dolby Pro Logic decoding modes.

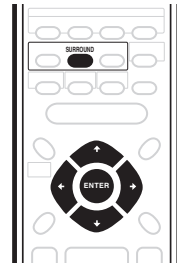

- Press **SURROUND** repeatedly to select a listening mode (or press **SURROUND** then use the **↑/↓** (cursor up/down) buttons).

The listening mode choices that appear in the display will vary according to the type of source that's playing.

- **Auto** – Auto listening mode (see above)
- **Dolby Digital / DTS** – Dolby Digital or DTS decoding (depending on the source). For a multichannel source, this will be the same as **Auto**.
- **Pro Logic** – 4.1 channel surround sound for use with any two-channel source
- **Movie** – Pro Logic II 5.1 channel surround sound, especially suited to movie sources, for use with any two-channel source

- **Music** – Pro Logic II 5.1 channel surround sound, especially suited to music sources, for use with any two-channel source (see also *Dolby Pro Logic II Music settings* below)
- **Stereo** – See *Listening in stereo* below

**Tip**

- See also *Using the Advanced Surround effects* below, for further stereo and surround playback options.

**Note**

- You can't use the Surround modes with high sampling rate 88.2 / 96 kHz sources.
- When listening in **Dolby Digital / DTS** mode, two-channel material will automatically be played in surround sound using Dolby Pro Logic decoding.
- Dolby Digital / DTS sources that use only the center channel cannot be played back in surround sound.

Dolby Pro Logic II Music settings

When listening in Dolby Pro Logic II Music mode, there are three further parameters you can adjust: Center Width, Dimension, and Panorama.

1 With Dolby Pro Logic II Music mode active, press SOUND MODE.

2 Use the ←/→ (cursor left/right) buttons to select 'C Width', 'Dimen.' or 'Pnrm.'

- **C Width** (Center Width): Makes the center channel wider (higher settings) or narrower (lower settings)
- **Dimen.** (Dimension): Makes the sound more distant (minus settings), or more forward (positive settings)

- **Pnrm.** (Panorama): Creates more spacious surround sound

3 Use the ↑/↓ (cursor up/down) buttons to adjust the setting.

Center Width is adjustable between **0** and **7**; Dimension between **-3** and **+3**. Panorama is **On** or **Off**.

4 Press ENTER to confirm.

Listening in stereo

You can listen to any source—stereo or multichannel, analog or digital—in stereo. When playing a multichannel source, stereo sound is created by downmixing all channels to the front left/right speakers and the subwoofer.

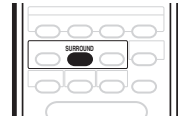

• **Press SURROUND repeatedly until 'Stereo' shows in the display.**

Any active Advanced Surround mode is cancelled.

**Tip**

- See also *Using the Advanced Surround effects* below, for further stereo and surround playback options.

Listening with headphones

When headphones are connected, only the **Stereo** (default) and **Phones Surround** (virtual surround sound for headphones) modes are available.

When you connect a pair of headphones, the listening mode automatically changes to **Stereo**. When you disconnect them it reverts to the previous mode.

- **With headphones connected, press **ADVANCED** to select 'Phones Surround' or **SURROUND** to select 'Stereo'.**

Using the Advanced Surround effects

Advanced Surround effects can be used with multichannel or stereo sources for a variety of additional surround sound effects.

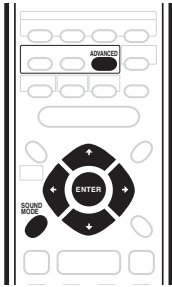

- **Press **ADVANCED** to select an Advanced Surround mode (or press **ADVANCED** then use the **↑/↓** (cursor up/down) buttons).**

Press repeatedly to select from:

- **Adv. Music** – Gives a concert hall-type sound
- **Adv. Movie** – Gives a movie theater-type sound
- **Expanded** – Creates an extra wide stereo field
- **TV Surr.** – Designed for mono or stereo TV broadcasts and other sources
- **Sports** – Designed for sports and other programs based on commentary
- **Game** – Creates surround sound from video game sources
- **ExPwrSurr.** (Extra Power Surround) – Gives additional energy and width to stereo sources

- **Virtual** – Creates the impression of surround sound from just the front speakers
- **5ch Stereo** – Designed to give powerful surround sound to stereo music sources

Note

- You can't use the Advanced Surround modes with high sampling rate 88.2 / 96 kHz sources.
- You can use any of the above Advanced Surround modes with any type of source. The descriptions are given only as a guide.

Adjusting the Advanced Surround effect level

You can emphasize or reduce the effect of the Advanced Surround modes as you like. For each Advanced Surround mode you can set the effect level independently.

1 With one of the Advanced Surround modes active, press **SOUND MODE.**

2 Use the **←/→ (cursor left/right) buttons to select 'Effect'.**

3 Use the **↑/↓ (cursor up/down) buttons to adjust the effect level.**

The effect level can be adjusted from **10** (min) to **90** (max).

4 Press **ENTER to confirm.**

Enhancing dialogue

- Default setting: **Dialog. Off**

The Dialogue Enhancement feature is designed to make the dialog stand out from other background sounds in a TV or movie soundtrack.

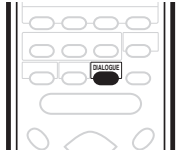

- **Press DIALOGUE to select the amount dialog enhancement.**

Press repeatedly to select from:

- **Dialog. Off** – No dialog enhancement
- **Dialog. Mid** – Moderate dialog enhancement
- **Dialog. Max** – Strong dialog enhancement



Note

- You can't use Dialog Enhancement with high sampling rate 88.2 / 96 kHz sources.

Listening with a virtual surround back speaker

- Default setting: **Vir. SB Off**

The Virtual Surround Back feature can be used when listening in surround sound to simulate an added surround back channel. In a real theater the surround back speaker would be directly behind you, creating more cohesive and realistic surround sound.

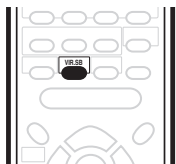

- **Press VIR. SB repeatedly to switch between 'Vir. SB On' and 'Vir. SB Off'.**



Note

- You can't use Virtual Surround Back when listening in **Stereo** or **Virtual** listening modes.
- If there is no surround channel, Virtual Surround Back has no effect.
- You can't use the Virtual Surround Back effect with high sampling rate 88.2 / 96 kHz sources, or with headphones.

Using Quiet and Midnight listening modes

- Default setting: **Off**

The Quiet listening feature reduces excessive bass or treble in a sound source. You can use this feature if the music is a little bit harsh and you would like a smoother sound.

The Midnight listening feature allows you to hear effective surround sound of movies at low volume levels. The effect automatically adjusts according to the volume at which you're listening.

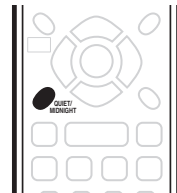

- **Press QUIET/MIDNIGHT (SHIFT + SOUND MODE) repeatedly to switch between 'Quiet', 'Midnight' and 'Off'.**

Adjusting the bass and treble

- Default setting: Bass: **0**, Treble: **0**

Use the bass and treble controls to adjust the overall tone.

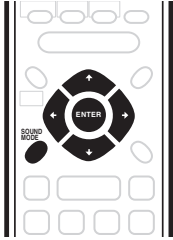

- 1 Press **SOUND MODE**.
- 2 Use the **←/→** (cursor left/right) buttons to select 'Bass' or 'Treble'.
- 3 Use the **↑/↓** (cursor up/down) buttons to adjust the sound. The bass and treble can be adjusted from **-3** to **+3**.
- 4 Press **ENTER** to confirm.



Note

- Bass and treble adjustment is not possible when the **Quiet** or **Midnight** modes are active.

Boosting the bass level

There are three bass modes you can use to enhance the bass in a source.

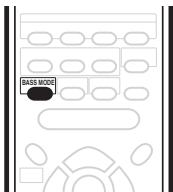

- Press **BASS MODE** repeatedly to choose an option that fits the source you're listening to.

- **Music** – Can be used with music to give a deeper bass sound
- **Cinema** – Good for action movies or movies with lots of sound effects
- **P. Bass** – Can be used with music sources to bring the beat of the music (or soundtrack) to the forefront
- **Off**



Note

- You can't use the bass mode when headphones are connected.

Muting the sound

Use the **MUTE** button if you need to momentarily turn off all sound from the speakers.

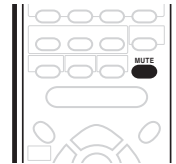

- Press **MUTE** to mute the volume. To cancel, adjust the volume or press **MUTE** again.

Chapter 6

Playing audio and video discs

Introduction

Most of the features described in this chapter make use of on-screen displays. For an explanation of how to navigate these, see *Using the on-screen displays* on page 28.

Many of the functions covered in this chapter apply to DVD discs, Video CDs, CDs and WMA/MP3/JPEG discs, although the exact operation of some varies slightly with the kind of disc loaded.

Some DVD discs restrict the use of some functions (random or repeat, for example). This is not a malfunction.

When playing Video CDs, some of the functions are not available during PBC playback. If you want to use them, start the disc playing using a number button to select a track.



Note

- If you want to play the MP3 or WMA tracks on a disc that also contains JPEG picture files, make sure that the **Photoviewer** option is set to **Off**. See *PhotoViewer* on page 72.

Playing only CDs, MP3 and WMA discs (CD mode)

Using this feature you can play only the CDs, MP3 and WMA discs loaded in the disc tray—automatically skipping over any DVDs and Video CDs loaded. This may be useful if you have a mixture of discs loaded but only want to play music: you don't have to keep track of what kind of disc is where in the disc tray.

1 Press **CD MODE** to switch CD mode on.

- The indicator on the front panel lights when CD mode is on.

2 Press **▶ (play)** to start playback.

The first CD loaded automatically starts to play.

Once all the CD/WMA/MP3 discs loaded have played, playback automatically stops.

- To cancel the CD mode, press **CD MODE** again.
- If you open the disc tray and load a DVD, Video CD or JPEG disc in the front-most position then press **▶ (play)** (on the front panel), CD mode is cancelled.



Note

- You can't switch on CD mode while playing a DVD or Video CD. Stop playback first.
- Although program play is not possible in CD mode, it is possible to program a playlist. When you start program playback, however, CD mode is cancelled.
- Repeat and random play is possible in CD mode (see *Using repeat play* on page 45 and *Using random play* on page 46).

Using the Disc Navigator to browse the contents of a disc

Use the Disc Navigator to browse through the contents of a disc to find the part you want to play. You can use the Disc Navigator when a disc is playing or stopped.



Important

- You can't use the Disc Navigator when playing a Video CD in PBC mode, or an unfinalized CD-R/RW disc.

1 Press HOME MENU and select 'Disc Navigator' from the on-screen display.

Alternatively, if a CD, Video CD, VR mode DVD-RW or WMA/MP3/JPEG disc is loaded, you can press **DVD MENU**, which takes you straight to the Disc Navigator screen.



2 Select what you want to play.

Depending on the type of disc you have loaded, the Disc Navigator looks slightly different.

The screen for DVD discs shows the titles on the left and the chapters on the right. Select a title, or a chapter within a title.

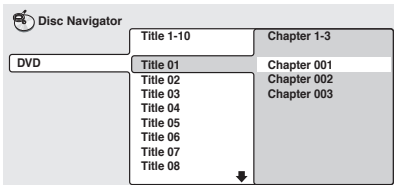

For a VR format DVD-RW disc select between the **Playlist** and **Original** areas of the disc, or a title. Press **→** (cursor right) to preview the title.

- You can't switch between **Original** and **Playlist** during playback.

- Not all VR format DVD-RW discs have a Playlist.

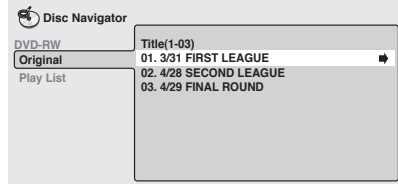

The screen for CDs and Video CDs shows a list of tracks.

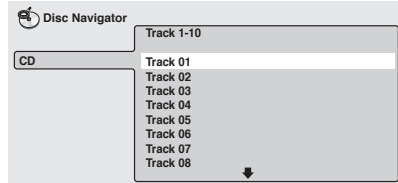

The screen for an WMA/MP3 disc shows the folder names on the left and the track names on the right (note that any folder and track names that contain accented or non-roman characters, will show up with generic names – **F_033**, **T_035**, etc.).

Select a folder, or a track within a folder.

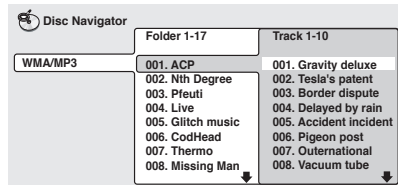

Playback starts after you press **ENTER**.



Tip

- You can't use the Disc Navigator when there are no discs loaded.

- Another way to find a particular place on a disc is to use one of the search modes. See *Searching a disc* on page 51.

Scanning discs

You can fast-scan discs forward or backward at various different speeds.

1 During playback, press ◀◀ or ▶▶ to start scanning.

2 Press repeatedly to increase the scanning speed.

- WMA/MP3 tracks can only be scanned at one speed.
- The scanning speed is shown on-screen.

3 To resume normal playback, press ▶ (play).



Note

- Sound can be heard while scanning audio CDs and MP3 discs.
- When scanning a Video CD or WMA/MP3 track, playback automatically resumes at the end or beginning of the track.
- There is no sound while scanning DVDs, WMA tracks and Video CDs, and no subtitles while scanning DVDs.
- Depending on the disc, normal playback may automatically resume when a new chapter is reached on a DVD disc.

Playing in slow motion

You can play DVDs and Video CDs at four different forward slow motion speeds. DVD discs can also be played at two reverse speeds.

1 During playback, press II (pause).

2 Press and hold ◀I/◀II or II▶/I▶ until slow motion playback starts.

- The slow motion speed is shown on-screen.
- There is no sound during slow motion playback.

3 Press repeatedly to change the slow motion speed.

- The slow motion speed is displayed on-screen.

4 To resume normal playback, press ▶ (play).



Note

- Video CD only supports forward slow motion playback.
- The picture quality during slow motion playback is not as good as during normal playback.
- Depending on the disc, normal playback may automatically resume when a new chapter is reached.

Frame advance/frame reverse

You can advance or back up DVD-Video discs frame-by-frame. With Video CDs and VR mode DVD-RW discs, you can only use frame advance.

1 During playback, press II (pause).

2 Press ◀I/◀II or II▶/I▶ to reverse or advance a frame at a time.

3 To resume normal playback, press ▶ (play).



Note

- The picture quality when using frame reverse is not as good as frame advance.
- Depending on the disc, normal playback may automatically resume when a new chapter is reached.
- When changing direction with a DVD disc, the picture may 'jump'. This is not a malfunction.

Looping a section of a disc

The A-B Repeat function allows you to specify two points (A and B) within a track (CD and Video CD) or title (DVD-Video and DVD-RW) that form a loop which is played over and over.



Important

- You can't use A-B Repeat with WMA/MP3 discs, Video CDs in PBC mode, unfinalized CD-R/RW discs, or VR format DVD-RW discs.

1 During playback, press HOME MENU and select 'Play Mode'.

2 Select 'A-B Repeat' from the list of functions on the left.

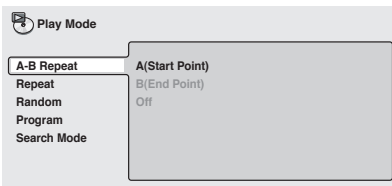

3 Press ENTER on 'A(Start Point)' to set the loop start point.

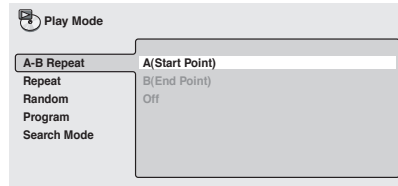

4 Press ENTER on 'B(End Point)' to set the loop end point.

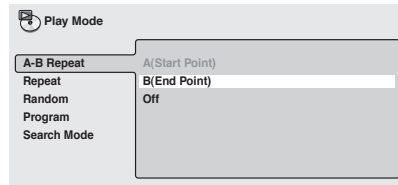

After pressing **ENTER**, playback jumps back to the start point and plays the loop.

- The minimum loop time is 2 seconds.

5 To resume normal playback, select 'Off' from the menu.

Using repeat play

There are various repeat play options, depending on the kind of disc loaded. It's also possible to use repeat play together with program play to repeat the tracks/chapters in the program list (see *Creating and editing a DVD program list* on page 47 and *Creating and editing a non-DVD program list* on page 49).



Important

- Repeat play is not available with Video CDs in PBC mode, or unfinalized CD-R/RW discs.

- 1 During playback, press **HOME MENU** and select 'Play Mode'.
- 2 Select 'Repeat' from the list of functions on the left.

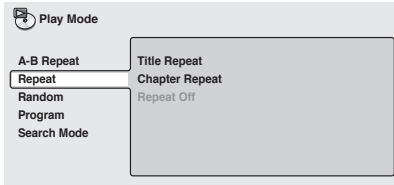

- 3 Select a repeat play option.
- If program play is active, select **Program Repeat** to repeat the program list, or **Repeat Off** to cancel.

For DVD discs, select **Title Repeat** or **Chapter Repeat** (or **Repeat Off**).

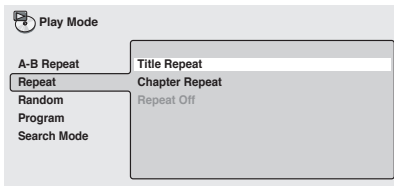

For CDs and Video CDs, select **All Discs Repeat**, **Disc Repeat** or **Track Repeat** (or **Repeat Off**).

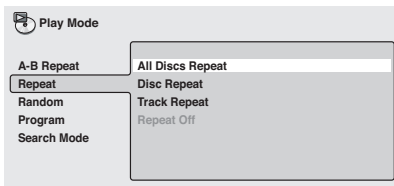

For WMA/MP3 discs, select **All Discs Repeat**, **Disc Repeat**, **Folder Repeat** or **Track Repeat** (or **Repeat Off**).

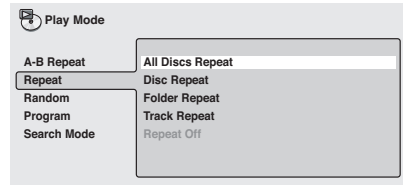

Tip

- You can also use the **REPEAT (SHIFT + 2)** button on the remote to select a repeat play mode. The repeat mode is indicated in the front panel display and on-screen. The repeat modes available are the same as when choosing from the Play Mode menu.

Note

- If you switch camera angle during repeat play, repeat play is canceled.

Using random play

With a DVD you can choose to play titles or chapters within a title in a random order. With CDs, Video CDs, MP3 or WMA discs, you can play all the discs at random, or just the contents of a single disc.

You can set the random play option when a disc is playing or stopped.

Important

- You can't use random play with VR format DVD-RW discs, Video CDs playing in PBC mode, or while a DVD disc menu is being displayed.

1 Press **HOME MENU** and select 'Play Mode'.

2 Select 'Random' from the list of functions on the left.

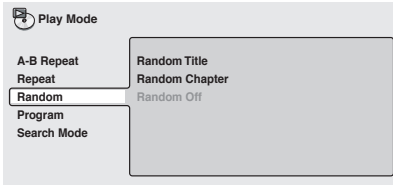

3 Select a random play option.

For DVD discs, select **Random Title** or **Random Chapter** (or **Random Off**)

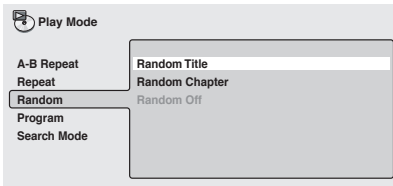

For CDs, Video CDs and WMA/MP3 discs, select **Random All**, **Random Disc** (or **Random Off**).

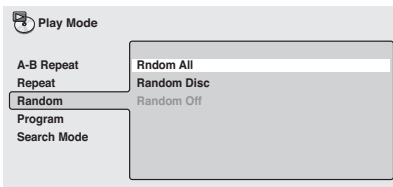

- The **Random All** function ignores DVDs loaded in the player.



Tip

- You can also use the **RANDOM (SHIFT + 3)** button on the remote to select a random play mode. The random mode is indicated in the front panel display and on-screen. The random modes available are the same as when choosing from the Play Mode menu. Press **ENTER** to start random play.
- To stop the disc and cancel random playback, press **■** (stop).
- To cancel random playback without stopping playback, press **CLEAR**. The disc will play to the end, then stop.
- During random play, the **⏮** and **⏭** buttons function a little differently to normal: **⏮** returns to the beginning of the current track/chapter. You can't go back further than this. **⏭** selects another track/chapter at random from those remaining.
- You can't use random play together with program or repeat play.

Creating and editing a DVD program list

This feature lets you program the play order of titles and chapters on the DVD disc currently in the play position.

If you want to program the play order of CDs, Video CDs, MP3 or WMA discs, see *Creating and editing a non-DVD program list* on page 49.



Important

- You can't use Program play with VR format DVD-RW, Video CDs playing in PBC mode, or while a DVD disc menu is being displayed.

1 Make sure that the DVD disc you want to make the program list for is in the play position.

Use the **DISC** select buttons on the remote, or the **DIRECT PLAY** buttons on the front panel to select the disc.

2 Press HOME MENU and select 'Play Mode'.

- Alternatively, press **PROGRAM (SHIFT + 1)** and skip to step 5.

3 Select 'Program' from the list of functions on the left.

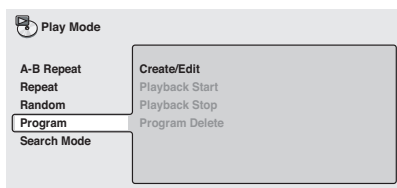

4 Select 'Create/Edit' from the list of program options.

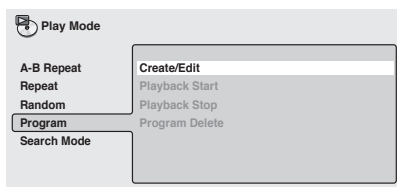

5 Select a title or chapter for the first/next step in the program list.

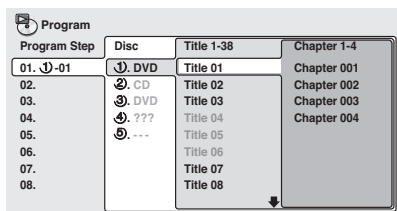

- When this screen first appears, the first title on the disc is highlighted. From here you can select a title, or a chapter within a title.
- Some titles and/or chapters of DVD discs may be grayed out, depending on the disc. Grayed out titles/chapters can't be added to the program list.

6 Press ENTER to add the highlighted item to the program list.

The program step number automatically moves to the next position.

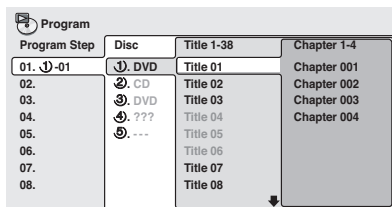

7 Add further items to the program list in the same way.

- A program list can contain up to 24 steps.
- To clear a step in the program list, move to the **Program Step** column, highlight the step to clear and press **CLEAR**.
- To insert a step in the program list, move to the **Program Step** column and highlight the step where you want a new step to appear. After you select a title/chapter, all the program steps will move down one to make space for the new one.

8 To play the program list, press ► (play).

- Program play remains active until you turn off program play (see below), erase the program list (see below), or switch off the system.

Creating and editing a non-DVD program list

This feature lets you program the play order of folders and tracks on the CDs, Video CDs and WMA/MP3 discs loaded.

If you want to program the play order of a DVD disc, see *Creating and editing a DVD program list* on page 47.

Important

- You can't use program play with Video CDs playing in PBC mode, or with unfinalized CD-R/RW discs.

1 Make sure that a non-DVD disc is in the play position.

Use the **DIRECT PLAY** buttons on the front panel to select a disc.

2 Press HOME MENU and select 'Play Mode'.

- Alternatively, press **PROGRAM (SHIFT + 1)** and skip to step 5.

3 Select 'Program' from the list of functions on the left.

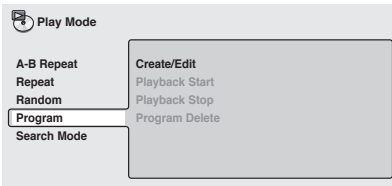

4 Select 'Create/Edit' from the list of program options.

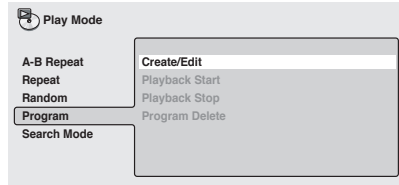

5 Select a folder or track for the first/next step in the program list.

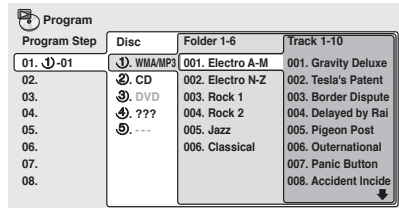

- When this screen first appears, the first folder or track of the disc in the play position is highlighted. From here you can select something on this disc, or move left to the **Disc** column and select something from one of the other discs loaded.
- With WMA/MP3 discs, you can select a folder, or an individual track in a folder.
- With CDs and Video CDs, select a track.
- Any DVDs loaded are shown grayed out and can't be selected.
- If the system has not yet determined the type of disc in a tray position, '???' is displayed as the disc type. If you select it, '???' is displayed in the middle and right columns. You can add items to the program list from this disc, although what you select must actually exist on the disc for it to play. Also, if the disc is a DVD, program play will be cancelled when it comes to that disc in the program list

- If a tray position is empty, '— —' is displayed.

6 Press ENTER to add the highlighted item to the program list.

The program step number automatically moves to the next position.

Program Step	Disc	Folder 1-6	Track 1-10
01. ⏮ -001-003	Ⓛ W/M/A/M/P/S	001. Electro A-M	001. Gravity Deluxe
02. ⏮ -001-003	Ⓛ CD	002. Electro N-Z	002. Testa's Patent
03.	Ⓛ DVD	003. Rock 1	003. Border Dispute
04.	Ⓛ ???	004. Rock 2	004. Delayed by Rai
05.	Ⓛ ...	005. Jazz	005. Pigeon Post
06.		006. Classical	006. International
07.			007. Panic Button
08.			008. Accident Incide

7 Add further items to the program list in the same way.

- A program list can contain up to 24 steps.
- To clear a step in the program list, move to the **Program Step** column, highlight the step to clear and press **CLEAR**.
- To insert a step in the program list, move to the **Program Step** column and highlight the step where you want a new step to appear. After you select a folder/track, all the program steps will move down one to make space for the new one.

8 To play the program list, press ► (play).

- Program play remains active until you turn off program play (see below), erase the program list (see below), or switch off the system.



Tip

- To save your program list and exit the program edit screen without starting playback, press **HOME MENU**. (Don't press **RETURN**—your program list won't be saved.)

- During program play, press ►►1 to skip to the next program step.
- Press **CLEAR** during playback to switch off program play. Press while stopped to erase the program list.



Note

- The current playlist is erased if you change the type of disc in the play position (DVD or non-DVD) or select **Program Delete** from the **Play Mode** menu.
- DVD playback follows commands recorded on the disc. There may be cases where program play is automatically cancelled or may not work. This is not a malfunction.
- With Video CDs that feature PBC playback, make sure that the disc is stopped before you start making the program list.

Other functions available from the program menu

As well as creating and editing a program list, you can start program play, cancel program play, erase the program list from the Play Mode menu.

1 Press HOME MENU and select Play Mode.

Play Mode	
A-B Repeat	Create/Edit
Repeat	Playback Start
Random	Playback Stop
Program	Program Delete
Search Mode	

2 Select a program play function.

- **Create/Edit** – See above
- **Playback Start** – Starts playback of a saved program list
- **Playback Stop** – Turns off program play, but does not erase the program list
- **Program Delete** – Erases the program list and turns off program play

Searching a disc

You can search DVD discs by title or chapter number, or by time. CDs can be searched by track number, and Video CDs by track number or time. WMA/MP3 discs can be searched by folder or track number.



Important

- You can't use the search functions with Video CDs in PBC mode, or unfinalized CD-R/RW discs.

1 Press HOME MENU and select 'Play Mode'.

2 Select 'Search Mode' from the list of functions on the left.

The search options that appear depend on the kind of disc loaded. The screen below shows the DVD search options.

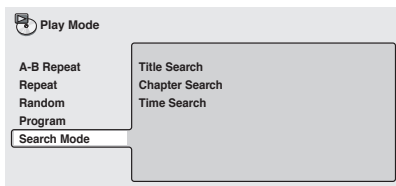

3 Select a search mode.

4 Use the number buttons to enter a title, chapter, folder or track number, or a time.

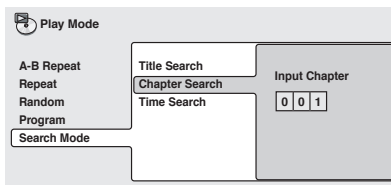

- For a time search, enter the number of minutes and seconds into the currently playing title (DVD) or track (Video CD) you want playback to resume from. For example, press **4, 5, 0, 0** to have playback start from 45 minutes into the disc. For 1 hour, 20 minutes and 30 seconds, press **8, 0, 3, 0**.

5 Press ENTER to start playback.



Note

- The disc must be playing in order to use time search.

Switching DVD audio language

When playing a DVD disc recorded with dialog in two or more languages, you can switch audio language during playback.

- **Press AUDIO repeatedly to select an audio language option.**

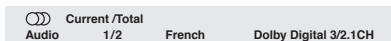

**Note**

- Some discs only allow you to change audio language from the disc menu. Press **DVD MENU** to access.
- To set audio language preferences, see *Audio Language* on page 68.

Switching subtitles

Some DVD discs have subtitles in one or more languages; the disc box will usually tell you which subtitle languages are available. You can switch subtitle language during playback.

- Press **SUBTITLE** repeatedly to select a subtitle option.

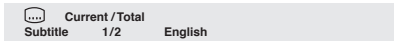
**Note**

- Some discs only allow you to change subtitle language from the disc menu. Press **DVD MENU** to access.
- To set subtitle preferences, see *Subtitle Language* on page 68.

Switching audio channel when playing a Video CD

When playing a Video CD, you can switch between stereo, just the left channel or just the right channel.

- Press **AUDIO** repeatedly to select an audio channel option.



Zooming the screen

Using the zoom feature you can magnify a part of the screen by a factor of 2 or 4, while watching a DVD or Video CD.

- 1 During playback, use the **ZOOM** button to select the zoom factor.

- Normal
- 2x
- 4x

Normal

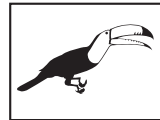

Zoom 2x

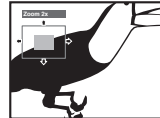

Zoom 4x

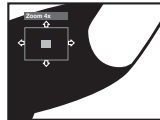

- Since DVD and Video CD has a fixed resolution, picture quality will deteriorate, especially at 4x zoom. This is not a malfunction.

- 2 Use the cursor buttons to change the zoomed area.

You can change the zoom factor and the zoomed area freely during playback.

- If the navigation square at the top of the screen disappears, press **ZOOM** again to display it.



Note

- We do not recommend using DVD disc menus when the screen is zoomed as menu options will not be highlighted.
- If you are displaying subtitles, these will disappear when the screen is zoomed. They will reappear when you return the screen to normal.

Switching camera angles

Some DVD discs feature scenes shot from two or more angles—check the disc box for details.

When a multi-angle scene is playing, a  icon appears on screen and in the front panel display to let you know that other angles are available (this can be switched off if you prefer—see *Angle Indicator* on page 70).

- **During playback (or when paused), press ANGLE to switch angle.**



Displaying disc information

Various track, chapter and title information, as well as the video transmission rate for DVD discs, can be displayed on-screen while a disc is playing.

- **To show/switch the information displayed, press DISPLAY (SHIFT + 8).**

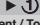

When a disc is playing, the information appears at the top of the screen. Press **DISPLAY (SHIFT + 8)** repeatedly to change the displayed information.

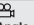
- DVD displays

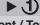
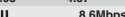
Play  DVD					
	Current / Total	Elapsed	Remain	Total	
Title	11/38	2.05	4.57	7.02	
Audio	1. French		1. English		1
Tr. Rate	Dolby Digital 3/2.1CH		8.6Mbps		Angle

Play  DVD					
	Current / Total	Elapsed	Remain	Total	
Chapter	11/38	2.05	4.57	7.02	
Tr. Rate			8.6Mbps		

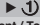
- VR format DVD-RW displays

Play  DVD-RW Original					
	Current / Total	Elapsed	Remain	Total	
Title	1/32	0.08	30.22	30.30	
Audio	1		--		
Tr. Rate	Dolby Digital 2/0CH		8.6Mbps		

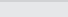
Play  DVD-RW Original					
	Current / Total	Elapsed	Remain	Total	
Chapter	1/1				
Tr. Rate			4.3Mbps		

- CD and Video CD displays

Play  CD				
	Elapsed	Remain	Total	
Disc	28.00	30.20	58.20	

Play  CD				
	Current / Total	Elapsed	Remain	Total
Track	2/16	1.07	4.40	5.47

- MP3 / WMA disc displays

Play  MP3				
	Current / Total	Elapsed	Remain	Total
Track	1/17	0.18	12.42	13.00
Track Name	Ournational			

Play  MP3				
	Current / Total	Elapsed	Remain	Total
Folder	2/7			
Folder Name	ACP			

- JPEG disc displays

Play	▶ ↕ JPEG
Current / Total	
File	1/40
File Name	FL000001

Play	▶ ↕ JPEG
Current / Total	
Folder	2/6
Folder Name	Holiday



Note

- You can see disc information (number of titles/chapters, tracks, folders and so on) from the Disc Navigator screen. See *Using the Disc Navigator to browse the contents of a disc* on page 42.

Front panel display information

Limited disc information also appears in the front panel display. Press **DISPLAY (SHIFT + 8)** to change the displayed information.

- DVD / DVD-RW displays

2 · 2	8' 49"	Disc no. Chapter no. Elapsed title time
-------	--------	---

2 · T 1 1	07' 00"	Disc no. Title no. Remaining title time
-----------	---------	---

2 · 2	0' 42"	Disc no. Chapter no. Remaining chapter time
-------	--------	---

- CD and Video CD displays

1 · 4 · 1' 16"	Disc no. Track no. Elapsed track time
----------------	---

1 · 4 · 3' 20"	Disc no. Track no. Remaining track time
----------------	---

1 · D s c · 53' 15"	Disc no. Remaining disc time
---------------------	---------------------------------

- MP3 / WMA disc displays

4 · 2 · 0' 35"	Disc no. Track no. Elapsed track time
----------------	---

4 · E V E R Y B O D	Disc no. Track name
---------------------	------------------------

4 · B E S T _ O F _	Disc no. Folder name
---------------------	-------------------------

- JPEG disc displays

2 · T I G E R _ 0 1	Disc no. File name
---------------------	-----------------------

2 · Z O O _ T R I P	Disc no. Folder name
---------------------	-------------------------

Chapter 7

Viewing JPEG discs

Playing a JPEG slideshow

After loading a CD/CD-R/RW containing JPEG pictures, press ► (play) to start a slideshow from the first folder/picture on the disc. The pictures in each folder are displayed in alphabetical order.

Pictures are automatically adjusted so that they fill as much of the screen as possible (if the aspect ratio of the picture is different to your TV screen you may notice black bars at the sides, or at the top and bottom of the screen).

While the slideshow is running:

Button	What it does
II	Pauses the slideshow; press again to restart.
◀◀	Displays the previous picture. Use with SHIFT to jump to the first file in the previous folder.
▶▶	Displays the next picture. Use with SHIFT to jump to the first file in the next folder.
ANGLE	Pauses the slideshow and rotates the currently displayed picture 90° clockwise. Press ► (play) to restart slideshow).
ZOOM	Pauses the slideshow and zooms the screen (see below). Press ► (play) to restart slideshow).
DVD MENU	Displays the Disc Navigator screen (see below).



Note

- The **II**, **ANGLE** and **ZOOM** buttons do not work while the display shows **LOADING**.
- The time it takes for a file to load increases with large file sizes.
- Up to 999 files are viewable on a disc. If there are more files than this on a disc, only the first 999 files are viewable.
- If you want to play the MP3 or WMA tracks on a disc that also contains JPEG picture files, you should first set the **Photoviewer** option to **Off**. See **PhotoViewer** on page 72.

Using the JPEG Disc Navigator and Photo Browser

Use the JPEG Disc Navigator to find a particular folder or picture by filename on the disc in the play position; use the Photo Browser to find a picture within a folder by thumbnail image.

1 Press DVD MENU to display the Disc Navigator screen.

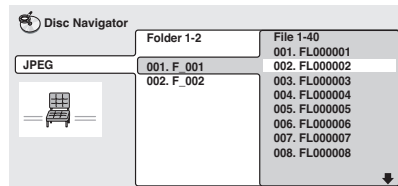

The left column shows the folders on the disc, the right column shows the files in a folder. (note that any folder and file names that contain accented or non-roman characters, will show up with generic names – **F_033**, **FL000035**, etc.).

2 Use the cursor buttons (↑/↓/←/→) to navigate.

When a file is highlighted, a thumbnail image is displayed.

- When a folder is highlighted you can press **ENTER** to open the Photo Browser screen for that folder. See below for more on using the Photo Browser.

3 To resume the slideshow from the highlighted file, press ENTER.

Using the Photo Browser

The Photo Browser displays nine thumbnail images at a time from the current folder.

1 From the Disc Navigator screen, highlight a folder to display then press ENTER.

The Photo Browser screen opens with the first nine pictures displayed as thumbnails.

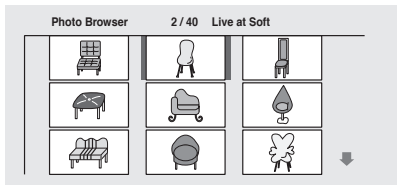

2 Use the cursor buttons (↑/↓/←/→) to highlight a thumbnail picture.

- Use the track skip buttons (I◀◀ and ▶▶I) to see the previous / next page of thumbnails. Keep the button pressed if you want to skip several pages; release when you reach the page you want.
- To return to the Disc Navigator screen, press **RETURN**.

3 Press ENTER to display the selected thumbnail full size on screen.

The slideshow resumes from the selected picture.

Zooming the screen

Using the zoom feature you can magnify a part of the screen by a factor of 2 or 4, while viewing pictures from a JPEG disc.

1 During slideshow playback, use the ZOOM button to select the zoom factor.

- Normal
- 2x
- 4x

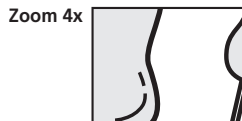
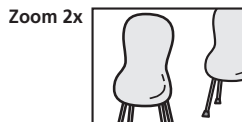
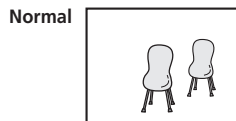

- The slideshow is paused when the screen is zoomed.
- Since JPEG pictures have a fixed resolution, picture quality may deteriorate, especially at 4x zoom. This is not a malfunction.

2 Use the cursor buttons (↑/↓/←/→) to change the zoomed area.

You can change the zoom factor and the zoomed area freely.

- When you change the zoom area, this becomes the new 'default' zoom area for the disc loaded.

3 To resume the slideshow, press ► (play).

Chapter 8

Using the timer

Setting the wake-up timer

Use the wake-up timer to set the system to switch on at any time and start playing whatever source you want.

**Important**

- The clock must be set to the correct time for the wake-up timer to work properly (see *Setting the clock* on page 27).

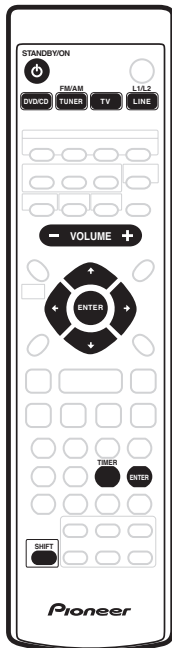
**1 Select the source you want played.**

For example, press **TUNER (TUNER FM/AM/ST.** on the front panel) to select the radio as your source.

2 Prepare the source.

For example, tune in the radio station you want to wake up to.

If you've selected a CD, make sure that it's stopped.

3 Set the volume.**4 Press TIMER (SHIFT + 6) twice to reach the timer menu.****5 Use the ←/→ (cursor left/right) buttons to select WAKE-UP then press ENTER.****6 Use the ←/→ (cursor left/right) buttons to select TIMER EDIT then press ENTER.****7 Set the switch-on time.**

Use the ↑/↓ (cursor up/down) buttons to set the hour, then press **ENTER**. Set the minute in the same way, pressing **ENTER** when you're done.

8 Set the switch-off time.

Use the ↑/↓ (cursor up/down) buttons to set the hour, then press **ENTER**. Set the minute in the same way, pressing **ENTER** when you're done.

After pressing **ENTER** this last time, the wake-up indicator lights, and the switch-on, switch-off times, the function (**DVD/CD**, etc.) and volume are confirmed in the display.

Using the timer

9 Switch the system into standby mode.

The wake-up timer will not work if the system is left on!



Tip

- You can check the timer settings in standby by pressing **TIMER (SHIFT + 6)** twice. (Press **TIMER (SHIFT + 6)** once to display the current time.)

Turning the wake-up timer on/off

If the wake-up timer is on, it will switch on the system everyday at the time you have set.

1 Press TIMER (SHIFT + 6) twice to reach the timer menu.

2 Use the ←/→ (cursor left/right) buttons to select WAKE-UP then press ENTER.

3 Use the ↑/↓ (cursor up/down) buttons to select TIMER ON or TIMER OFF.

- You must have the timer set (see above) to select **ON**. The wake-up timer switches on and off according to your previous settings.

4 Press ENTER.



Note

- The wake-up timer will automatically be canceled if the clock is reset.

Setting the sleep timer

The sleep timer switches off the system after a specified time so you can fall asleep without worrying about it.



Important

- If you set the sleep timer while either the wake-up timer is active, the earlier switch off time takes priority.

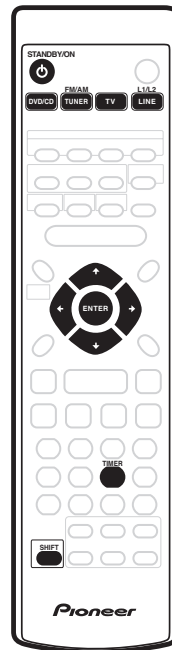

- 1 Press TIMER (SHIFT + 6) twice to reach the timer menu.**
- 2 Use the ←/→ (cursor left/right) buttons to select SLEEP TIMER then press ENTER.**
- 3 Use the ↑/↓ (cursor up/down) buttons to select a switch-off time then press ENTER.**

Choose between the following options:

- **Auto** – Available only in CD mode; the system switches off automatically after the currently playing disc has finished.
- **Sleep 90** – System switches off after 90 minutes
- **Sleep 60** – System switches off after an hour
- **Sleep 30** – System switches off after 30 minutes
- **Off** – cancels the sleep timer

- 4 To check how much time is left, repeat steps 1 and 2.**

The remaining time is displayed momentarily.

Chapter 9

Surround sound setup

Setting up surround sound

The Room Setup feature (page 27) is designed to give you a basic surround sound setup, however you can make the more detailed settings that may improve the surround sound in your listening room.

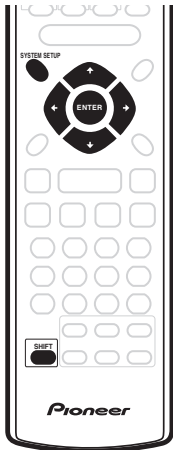

- 1 Press **SYSTEM SETUP (SHIFT + HOME MENU)**.
- 2 Use the **←/→ (cursor left/right) buttons to choose the setting you want to adjust.**
The current setting is shown for each option as you cycle through the display. See below for a full list and description of each.
- 3 Use the **↑/↓ (cursor up/down) buttons to adjust the setting.**
- 4 Repeat steps 2 and 3 to make other settings.

- 5 When you're done, press **ENTER** to leave the **System Setup** menu.



Note

- The System Setup menu is exited automatically after 5 minutes of inactivity.

System Setup menu options

Below are all the available settings in the setup menu. The first setting in each section is the default. See also the notes in each section for additional information about the settings.

Front speakers distance setting

Specifies the distance from your listening position to the front speakers:

- **Front 1 ft. ~ Front 30 ft.** – Distance can be set in increments of 1 ft. The default is 10 ft.

Center speaker distance setting

Specifies the distance from your listening position to the center speaker:

- **Center 1 ft. ~ Center 30 ft.** – Distance can be set in increments of 1 ft. The default is 10 ft.

Surround speakers distance setting

Specifies the distance from your listening position to the front speakers:

- **Surr. 1 ft. ~ Surr. 30 ft.** – Distance can be set in increments of 1 ft. The default is 10 ft.

Dynamic Range Control

Specifies the amount of dynamic range adjustment to Dolby Digital or DTS soundtracks:

- **DRC Off** – No dynamic range adjustment (use when listening at higher volume)
- **DRC Mid** – Mid setting
- **DRC High** – Dynamic range is reduced (loud sounds are reduced in volume while quieter sounds are increased)



Note

- This setting works only with Dolby Digital and some DTS soundtracks. For other sources you can create a similar effect using the Midnight mode (see *Using Quiet and Midnight listening modes* on page 40).

Dual mono setting

Specifies how dual mono encoded Dolby Digital or DTS soundtracks should be played. You can also use this setting to switch the audio channel on DVD-RW discs recorded with two separate soundtracks.

- **L-ch1 R-ch2** – Both channels are played through the front speakers
- **CH1 Mono** – Only channel 1 is played
- **CH2 Mono** – Only channel 2 is played



Note

- On the **Ch1 Mono** and **Ch2 Mono** settings the sound comes only from the center speaker (or from the front speakers if listening in **STEREO** mode).
- This setting works only with dual mono encoded Dolby Digital or DTS soundtracks. See the disc packaging for channel information.

LFE attenuator setting

Dolby Digital and DTS audio sources include ultra-low bass tones. Set the LFE attenuator as needed to prevent the ultra-low bass from distorting the sound.

- **LFE ATT 0** – The LFE channel is played with no attenuation
- **LFE ATT 10** – LFE channel is attenuated by 10dB
- **LFE Off** – LFE channel is not played

Setting the channel levels

You can set the relative channel levels from your main listening position for each listening mode, including all the Surround and Advanced Surround modes.

If you used the Room Setup feature (page 27), the channel levels for each listening mode will already be set. However, you can still fine-tune the levels here if you need to.

1 Press SURROUND or ADVANCED repeatedly to select a listening mode.

2 Press TEST TONE (SHIFT + 4) to hear the test tone.

The test tone is output in the following order (from the speakers active in the current listening mode):

- **FL** – Front left speaker
- **C** – Center speaker
- **FR** – Front right speaker
- **RS** – Right surround speaker
- **LS** – Left surround speaker
- **SW** – Subwoofer

3 Use the VOLUME +/- button to adjust the volume to an appropriate level.

4 Use the ↑/↓ (cursor up/down) buttons to adjust the speaker levels in turn.

You should hear the test tone at the same volume from each speaker when seated in the main listening position. The channel level range is ± 10 dB.

5 When you're done, press ENTER to exit test tone setup.



Tip

- The speaker volume can be adjusted while listening to any sound source you want by pressing **CH LEVEL (SHIFT + 5)** and then using the ↑/↓ (cursor up/down) buttons to adjust the channel levels. After you're finished with one channel, use the ←/→ (cursor left/right) buttons to move to the next.



Note

- Since the subwoofer produces ultra-low frequencies its sound may seem quieter than it actually is.

Chapter 10

Video Adjust menu

Video Adjust

- Default setting: **Standard**

From the Video Adjust screen you can select the standard video presentation or define presets of your own.

- 1 Press **HOME MENU** and select 'Video Adjust' from the on-screen display.

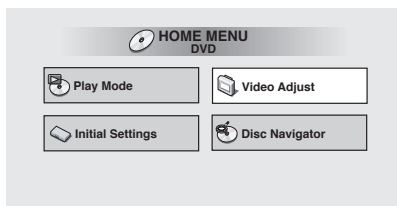

- 2 Use the **←/→** (cursor left/right) buttons to select a preset.

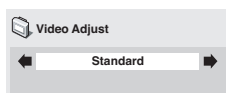

- **Standard**
- **Memory1–2** – Use for saving your own presets (see below)

- 3 Press **ENTER** to make the setting and exit the Video Adjust screen.

**Note**

- Depending on the disc and the TV/monitor, you may not see the effect clearly.

Creating your own presets

You can create up to three presets of your own.

- 1 Select one of the Memory presets (see above).
- 2 Press **↓** (cursor down) to select 'Detailed Settings' then press **ENTER**.

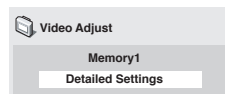

- 3 Adjust the picture quality settings.

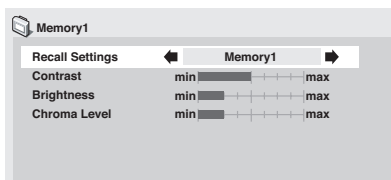

- Use the **↑/↓** (cursor up/down) buttons to select a setting.
- Use the **←/→** (cursor left/right) buttons to adjust the current setting.
- Press **DISPLAY (SHIFT + 8)** to switch between full and single view.
- You can change the preset number from the **Recall Settings** menu item.

You can adjust any or all of the following picture quality settings:

- **Contrast** – Adjusts the contrast between light and dark.
- **Brightness** – Adjusts the overall brightness.
- **Chroma Level** – Adjusts how saturated colors appear.

4 Press ENTER to save the preset and exit the Video Adjust screen.

Chapter 11

Initial Settings menu

Using the Initial Settings menu

The Initial Settings menu gives you complete control in setting up your DVD system, including video output settings and parental lock settings, among others.

If an option is grayed out it means that it cannot be changed at the current time. This is usually because a disc is playing. Stop the disc, then change the setting.

1 Press HOME MENU and select 'Initial Settings' from the on-screen display.

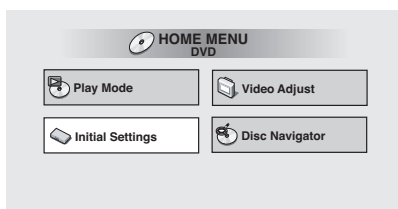

2 Select the setup category from the list on the left, then select an item from the menu list to the right.

3 Make the setting you want.



Note

- The language options shown in the on-screen display illustrations on the following pages may not correspond to those available in your country or region.

Video Output settings

TV Screen

- Default setting: **4:3 (Letter Box)**

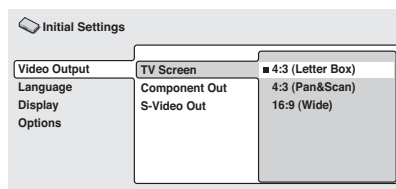

If you have a widescreen TV, select the **16:9 (Wide)** setting—widescreen DVD software is then shown using the full screen area. When playing software recorded in conventional (4:3) format, the settings on your TV will determine how the material is presented—see the manual that came with your TV for details on what options are available.

If you have a conventional TV, select either **4:3 (Letter Box)** or **4:3 (Pan & Scan)**. In Letter Box mode, widescreen software is shown with black bars at the top and bottom of the screen. Pan & Scan chops the sides off widescreen material to make it fit the 4:3 screen (so even though the image looks larger on the screen, you're actually seeing less of the picture). See also *Screen sizes and disc formats* on page 83.

Component Out

You only need to make this setting if you connected this system to your TV using the component video outputs.

- Default setting: **Interlace**

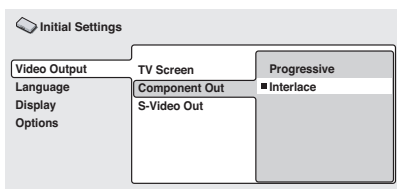

If you have a progressive-scan compatible TV, set this to **Progressive** for flicker-free video output. If your TV is not compatible with progressive-scan video, set to **Interlace**. Check the operating instructions that came with your TV if you're unsure about its compatibility.

When setting to **Progressive**, you have to press **ENTER** once more to confirm (or **RETURN** to cancel). See also below for important information on progressive scan video.

About progressive scan video

Compared to interlace video, progressive scan video effectively doubles the scanning rate of the picture, resulting in a very stable, flicker-free image. Progressive scan video is available only from the component video output.



Important

- When *Component Out* (above) is set to **Progressive**, there is no video output from the **VIDEO** and **S-VIDEO** jacks. If you want to display video on more than one monitor simultaneously, make sure that it is set to **Interlace**.

- If you connect a TV that is not compatible with a progressive scan signal and switch the system to progressive, you will not be able to see any picture at all. In this case, press **⏻ STANDBY/ON** to put the system in standby, then press and hold the front panel **■ (stop)** button for about 8 seconds until the display shows **Mem.Clr.?** Press the front panel **◀◀◀◀** or **▶▶▶▶** button so that the display shows **Interlace?** Press the front panel **▶/||** button to set to interlace and switch the system back on.

Compatibility of this system with progressive-scan TVs.

This system is compatible with progressive video Macro Vision System Copy Guard.

CONSUMERS SHOULD NOTE THAT NOT ALL HIGH DEFINITION TELEVISION SETS ARE FULLY COMPATIBLE WITH THIS PRODUCT AND MAY CAUSE ARTIFACTS TO BE DISPLAYED IN THE PICTURE. IN CASE OF 525 PROGRESSIVE SCAN PICTURE PROBLEMS, IT IS RECOMMENDED THAT THE USER SWITCH THE CONNECTION TO THE "STANDARD DEFINITION" OUTPUT. IF THERE ARE QUESTIONS REGARDING OUR TV SET COMPATIBILITY WITH THIS MODEL 525p DVD PLAYER, PLEASE CONTACT OUR CUSTOMER SERVICE CENTER.

This system is compatible with the following Pioneer displays and monitors: PDP-5030HD, PRO-1000HD, PRO-800HD, PDP-4330HD, PRO-720HD, PRO-620HD, PRO-520HD, SD-643HDS, SD-533HDS, PDP-503HDG, PDP-433HDG.

S-Video Out

You only need to make this setting if you connected this system to your TV using an S-video cable.

- Default setting: **S2**

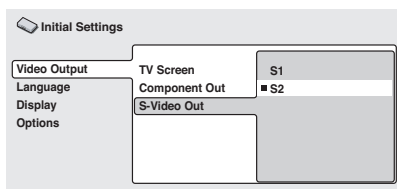

If you find that the picture is stretched or distorted on the default **S2** setting, try changing it to **S1**.

Language settings

Audio Language

- Default setting: **English**

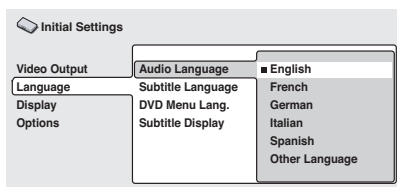

This setting is your preferred audio language for DVD discs. If the language you specify here is recorded on a disc, the system automatically plays the disc in that language. The DVD format recognizes 136 different languages. Select **Other Language** if you want to specify a language other than those listed. See also *Selecting languages using the language code list* on page 83.



Tip

- You can usually switch between the languages recorded on a DVD disc during playback using the **AUDIO** button. (This does not affect this setting.) See *Switching DVD audio language* on page 51.
- Some DVD discs set the audio language automatically when loaded, overriding the audio language you set in the Initial Settings menu.
- Discs with two or more audio languages usually allow you to select the audio language from the disc menu. Press **DVD MENU** to access the disc menu.

Subtitle Language

- Default setting: **English**

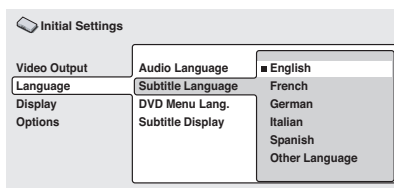

This setting is your preferred subtitle language for DVD discs. If the language you specify here is recorded on a disc, the system automatically plays the disc with those subtitles.

The DVD format recognizes 136 different languages. Select **Other Language** if you want to specify a language other than those listed. See also *Selecting languages using the language code list* on page 83.



Tip

- You can usually change or switch off the subtitles on a DVD disc during playback using the **SUBTITLE** button. (This does not affect this setting.) See *Switching DVD audio language* on page 51.
- Some DVD discs set the subtitle language automatically when loaded, overriding the subtitle language you set in the Initial Settings menu.
- Discs with two or more subtitle languages usually allow you to select the subtitle language from the disc menu. Press **DVD MENU** to access the disc menu.

DVD Menu Language

- Default setting: **w/Subtitle Lang.**

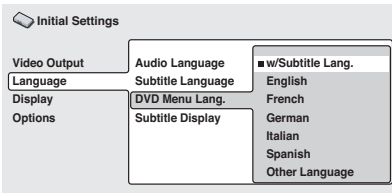

Some multilingual discs have disc menus in several languages. This setting specifies in which language the disc menus should appear. Leave on the default setting for menus to appear in the same language as the **Subtitle Language** setting—see above.

The DVD format recognizes 136 different languages. Select **Other Language** if you want to specify a language other than those listed. See also *Selecting languages using the language code list* on page 83.

Subtitle Display

- Default setting: **On**

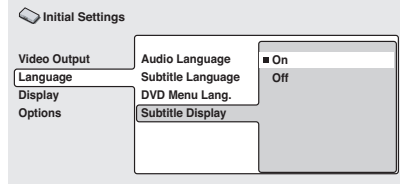

When set to **On**, the system displays subtitles according to the Subtitle Language setting. Set to **Off** to switch subtitles off altogether.

Display settings

OSD Language

- Default setting: **English**

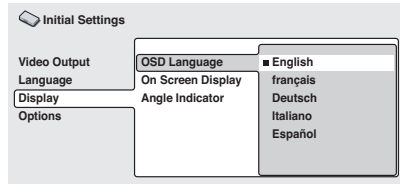

This sets the language of this system's on-screen displays.

On Screen Display

- Default setting: **On**

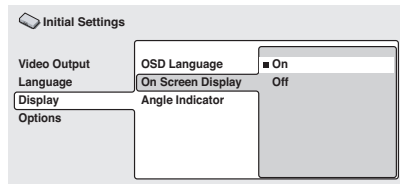

This sets whether operation displays are shown on-screen (**Play, Resume, Scan** and so on.) Note that when set to **Off**, you won't be able to display disc information on-screen.

Angle Indicator

- Default setting: **On**

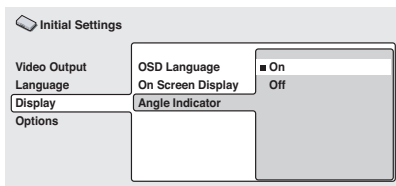

If you prefer not to see the camera icon on-screen during multi-angle scenes on DVD discs, change this setting to **Off**.

Options

Parental Lock

- Default level: **Off**
- Default password: *none*
- Default country code: **us (2119)**

Some DVD Video discs feature a Parental Lock level. If the player is set to a lower level than the disc, the disc won't play. This gives you some control about what your children watch on your DVD system.

Some discs also support the Country Code feature. Certain scenes on these discs will not be played, depending on the country code you set.

Before you can set the Parental Lock level or the Country Code you must register a password. As the password owner, you can change the Parental Lock level or Country Code whenever you like. You can also change the password.



Note

- Not all discs that you may consider inappropriate for your children use the Parental Lock feature. These discs will always play without requiring the password first.
- If you forget your password, you'll need to reset the system to its factory settings (see *Resetting the system* on page 74), then register a new password.

Registering a new password

You must register a password before you can change the Parental Lock level or enter a Country Code.

1 Select 'Password'.

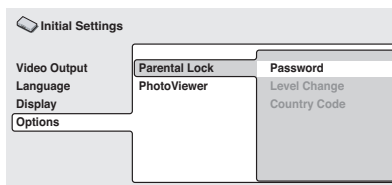

2 Use the number buttons to enter a 4-digit password.

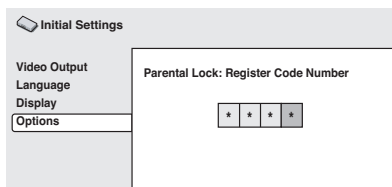

The numbers you enter show up as asterisks (*) on-screen.

3 Press ENTER to register the password and return to the Options menu screen.
If you forget your password, you can reset the system then register a new one. See *Resetting the system* on page 74 for how to reset the system.

Changing your password

To change your password, confirm your existing password then enter a new one.

1 Select 'Password Change'.

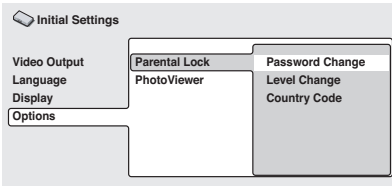

2 Use the number buttons to enter your existing password, then press ENTER.

The numbers appear as asterisks as you enter them.

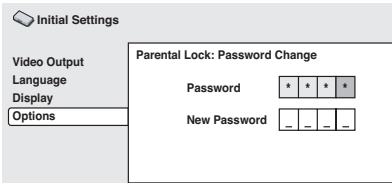

3 Enter a new password.

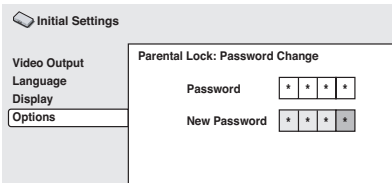

4 Press ENTER to register the new password and return to the Options menu screen.

Setting/changing the Parental Lock level

1 Select 'Level Change'.

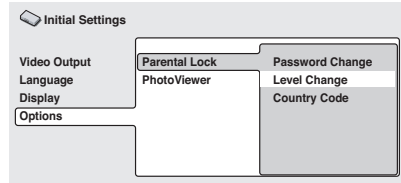

2 Use number buttons to enter your password, then press ENTER.

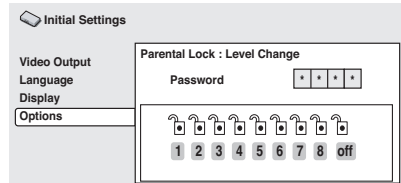

3 Select a new level.

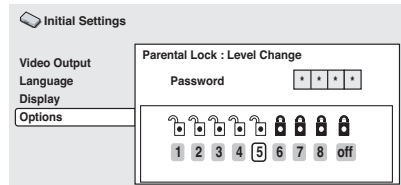

Press ← (cursor left) repeatedly to lock more levels (more discs will require the password); press → (cursor right) to unlock levels. You can't lock level 1.

4 Press ENTER to set the new level and return to the Options menu screen.

Setting/changing the Country Code

You may also want to refer to the *Country code list* on page 84.

1 Select 'Country Code'.

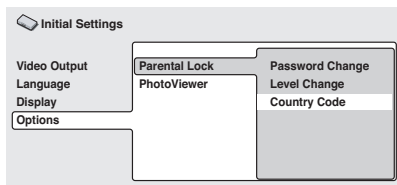

2 Use number buttons to enter your password, then press ENTER.

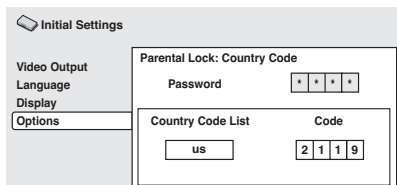

3 Select a country code.

There are two ways you can do this.

- Select by code letter: Use \uparrow/\downarrow (cursor up/down) to change the country code.

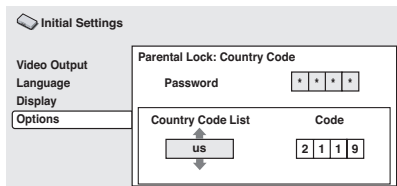

- Select by code number: Press \rightarrow (cursor right) then use the number buttons to enter the 4-digit country code (you can find the *Country code list* on page 84.)

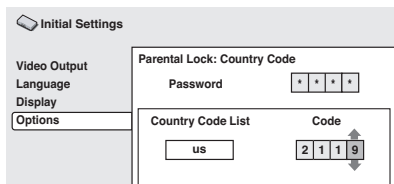

4 Press ENTER to set the new Country Code and return to the Options menu screen.

Note

- Changing the country code does not take effect until the next disc is loaded (or the current disc is reloaded).

PhotoViewer

- Default setting: **On**

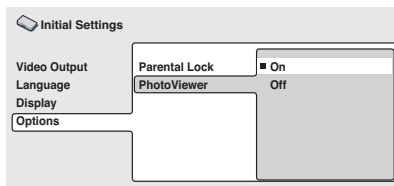

This setting is important if you load a disc that contains both WMA/MP3 audio files and JPEG picture files.

The default **On** setting allows you to view only the JPEG files on this kind of disc. Set to **Off** to be able to play the WMA/MP3 audio files.

Note that when this setting is changed, discs already loaded (other than in the play position) that contain both WMA/MP3 audio files and JPEG picture files will show up as **???** in the Disc Navigator and program list screens until they are reloaded.

Chapter 12

Additional information

Switching off the demo

- Default setting: **Demo On**

This system has an automatic demo feature that starts when the system is plugged in for the first time.

- 1 Switch the system into standby.
- 2 Press **SYSTEM SETUP (SHIFT + HOME MENU)**.
- 3 Use the **←/→ (cursor left/right)** buttons to select '**Demo MODE?**', then press **ENTER**.
- 4 Use the **↑/↓ (cursor up/down)** buttons to select '**Demo Off?**' (or '**Demo On?**') then press **ENTER** to confirm.



Note

- After setting the clock, the demo mode switches off automatically. However, if you unplug the system from the wall outlet, the demo mode will revert to **Demo On** (and the clock will be reset).

Child Lock

- Default setting: **Lock Off**

This system has a child lock feature that makes the front panel buttons and controls inoperative. This is useful when you've set the wake-up timer and don't want the system switched on before it activates.

- 1 Switch the system into standby.
- 2 Press **SYSTEM SETUP (SHIFT + HOME MENU)**.
- 3 Use the **←/→ (cursor left/right)** buttons to select '**Child Lock?**', then press **ENTER**.
- 4 Use the **↑/↓ (cursor up/down)** buttons to select '**Lock On?**' or '**Lock Off?**'.
- 5 Press **ENTER** to confirm.

Changing the clock format

- Default setting: **12-Hour**

You can choose to display the clock in either 12 or 24 hour formats.

- 1 Switch the system into standby.
- 2 Press **SYSTEM SETUP (SHIFT + HOME MENU)**.
- 3 Use the **←/→ (cursor left/right)** buttons to select '**12/24 Hour?**', then press **ENTER**.
- 4 Use the **↑/↓ (cursor up/down)** buttons to select either '**12-Hour?**' or '**24-Hour?**'.
- 5 Press **ENTER** to confirm.

Changing the frequency step

- Default setting: **FM100 AM 10**

If you find that you can't tune into stations successfully, the frequency step may not be suitable for your country/region.

- 1 Switch the system into standby.
- 2 Press **SYSTEM SETUP (SHIFT + HOME MENU)**.
- 3 Use the **←/→ (cursor left/right)** buttons to select 'FM AM STEP?', then press **ENTER**.
- 4 Use the **↑/↓ (cursor up/down)** buttons to select 'FM 50 AM 9?' or 'FM100 AM10?' then press **ENTER** to confirm.

Resetting the system

Use this procedure to reset all system settings to the factory default.

- 1 Switch the system into standby.
- 2 Press and hold the front panel **■ (stop)** button for about 8 seconds until the display shows 'Mem.Clr.?'
- 3 Press the front panel **▶/II** button.
All the system's settings are now reset, and you should see the 'Let's Get Started' screen.

Using and taking care of discs

Titles, chapters and tracks

DVD discs are generally divided into one or more titles. Titles may be further subdivided into chapters.

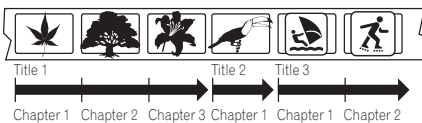

CDs and Video CDs are divided into tracks.

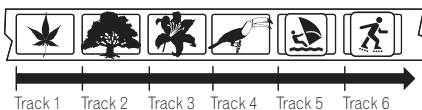

CD-ROMs contain folders and files. MP3 and WMA files are referred to as tracks. Folders may contain further folders.

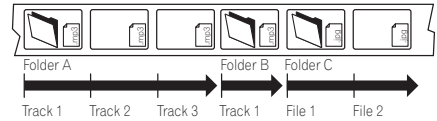

DVD Video regions

All DVD Video discs carry a region mark on the case somewhere that indicates which region(s) of the world the disc is compatible with. Your DVD system also has a region mark, which you can find on the rear panel. Discs from incompatible regions will not play in this system. Discs marked **ALL** will play in any player.

The diagram below shows the various DVD regions of the world.

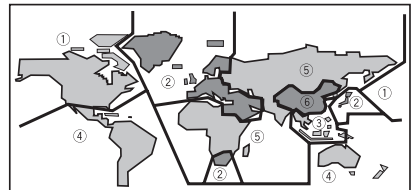

Handling discs

When holding discs of any type, take care not to leave fingerprints, dirt or scratches on the disc surface. Hold the disc by its edge or by the center hole and edge.

Damaged or dirty discs can affect playback performance. Take care also not to scratch the label side of the disc. Although not as fragile as the recorded side, scratches can still result in a disc becoming unusable.

Should a disc become marked with fingerprints, dust, etc., clean using a soft, dry cloth, wiping the disc lightly from the center to the outside edge as shown in the diagram below.



Wipe lightly from the center of the disc using straight strokes.



Don't wipe the disc surface using circular strokes.

If necessary, use a cloth soaked in alcohol, or a commercially available CD/DVD cleaning kit to clean a disc more thoroughly. Never use benzine, thinner or other cleaning agents, including products designed for cleaning vinyl records.

Storing discs

Although CDs and DVD discs are more durable than vinyl records, you should still take care to handle and store discs correctly. When you're not using a disc, return it to its case and store upright. Avoid leaving discs in excessively cold, humid, or hot environments (including under direct sunlight).

Don't glue paper or put stickers onto the disc, or use a pencil, ball-point pen or other sharp-tipped writing instrument. These could all damage the disc.



For more detailed care information see the instructions that come with discs.

Do not load more than one disc into the player at a time.

Discs to avoid

Discs spin at high speed inside the player. If you can see that a disc is cracked, chipped, warped, or otherwise damaged, don't risk using it—you could end up damaging the player.

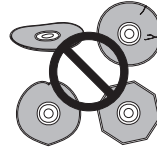

This system is designed for use with conventional, fully circular discs only. Use of shaped discs is not recommended for this product. Pioneer disclaims all liability arising in connection with the use of shaped discs.

Proper installation and maintenance of this system

Hints on installation

We want you to enjoy using this system for years to come, so please bear in mind the following points when choosing a suitable location for it:

Do...

- ✓ Use in a well-ventilated room.
- ✓ Place on a solid, flat, level surface, such as a table, shelf or stereo rack.

Don't...

- ✗ Use in a place exposed to high temperatures or humidity, including near radiators and other heat-generating appliances.

- ✗ Place on a window sill or other place where the system will be exposed to direct sunlight.
- ✗ Use in an excessively dusty or damp environment.
- ✗ Place directly on top of an amplifier, or other component in your stereo system that becomes hot in use.
- ✗ Use near a television or monitor as you may experience interference—especially if the television uses an indoor antenna.
- ✗ Use in a kitchen or other room where the system may be exposed to smoke or steam.
- ✗ Use on a thick rug or carpet, or cover with cloth—this may prevent proper cooling of the system unit.
- ✗ Place on an unstable surface, or one that is not large enough to support all four of the system unit's feet.

Cleaning the pickup lens

The DVD player's lens should not become dirty in normal use, but if for some reason it should malfunction due to dust or dirt, consult your nearest Pioneer authorized service center. Although lens cleaners are commercially available, we do not recommend using them since some may damage the lens.

Problems with condensation

Condensation may form inside the system unit if it is brought into a warm room from outside, or if the temperature of the room rises quickly. Although the condensation won't damage the system, it may temporarily impair its performance. For this reason you should leave it to adjust to the warmer temperature for about an hour before switching on and using.

Moving the system unit

If you need to move the main system unit, first remove all discs, then press  **STANDBY/ON** on the front panel to turn the system off. Wait for **Good Bye** to disappear from the display, then unplug the power cable. Never lift or move the system unit during playback—discs rotate at a high speed and may be damaged.



Note

- Unplugging the system before **Good Bye** disappears from the display may cause the system to return to the factory settings.

Power cable caution

Handle the power cable by the plug part. Do not pull out the plug by tugging the cable, and never touch the power cable when your hands are wet, as this could cause a short circuit or electric shock. Do not place the system unit, a piece of furniture, or other object on the power cable or pinch the cable in any other way. Never make a knot in the cable or tie it with other cables. The power cable should be routed so that they are not likely to be stepped on. A damaged power cable can cause a fire or give you an electric shock. Check the power cable once in a while. If you find it damaged, ask your nearest Pioneer authorized service center or your dealer for a replacement.

Connecting external antennas

External AM antenna

Use 5–6 meters (15–18 feet) of vinyl-insulated wire and set up either indoors or outdoors. Leave the AM loop antenna connected.

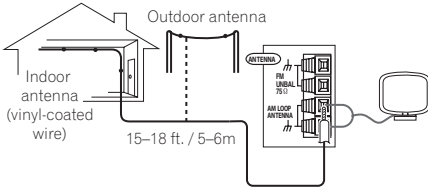

External FM antenna

Use 75Ω coaxial cable to hook up an external FM antenna.

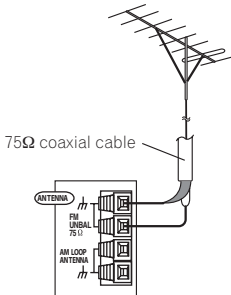

Connecting auxiliary components

This system has both stereo analog inputs and outputs, as well as a coaxial digital input. Use these to connect external components, such as your VCR, MD or CD-R recorder.

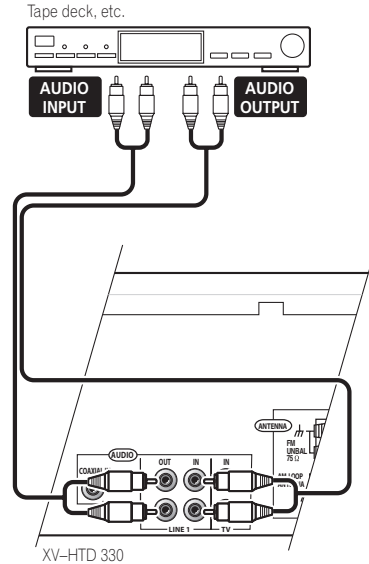

- **Connect the LINE 1 (IN) jacks to the analog outputs of an external playback component.**

These include components such as a VCR or cassette deck. Connect using RCA pin-plug stereo cables. See also *Reducing the TV and line signal levels* below.

- **Connect the LINE 1 (OUT) jacks to the analog inputs of an external recording component.**

These include components such as a cassette deck, VCR, MD or another recorder with analog inputs. Connect using RCA pin-plug stereo cables.

- Connect the **COAX IN (LINE 2)** jack on the rear panel to the coaxial digital output of an external playback component.

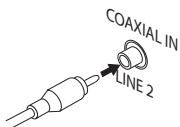

These include digital components such as an MD player, digital satellite, or a game system. Connect using a coaxial digital cable (not supplied).

Reducing the TV and line signal levels

- Default setting: **ATT 6dB**

Some sources may produce a high signal level which may produce unpleasant distortion from the speakers. In such cases, you may need to reduce the signal level of the auxiliary source (connected to the **TV** or **LINE 1** analog inputs) by switching on the attenuator.

- 1 Switch the system into standby.
- 2 Press **SYSTEM SETUP (SHIFT + HOME MENU)**.
- 3 Use the **←/→ (cursor left/right)** buttons to select '**TV ATT ?**' or '**LINE1 ATT?**', then press **ENTER**.
- 4 Use the **↑/↓ (cursor up/down)** buttons to select '**ATT OFF**', '**ATT 6dB**' or '**ATT 10dB**'.

If the **ATT 6dB** setting still results in distorted sound, try the **ATT 10dB** setting.

- 5 Press **ENTER** to confirm.

Recording mode

The Recording mode allows you to make analog recordings from the **LINE 1 (OUT)** jacks.

When Recording mode is on, most sound-related functions (including **SURROUND**, **ADVANCED**, **AUTO**, **SYSTEM SETUP**) become inactive. The display will briefly blink **RecMode On** if you try and use a prohibited function while Recording mode is on.

When Recording mode is off, the audio from the analog output may be interrupted, depending on the operation.

- 1 Press **SOUND MODE**.
- 2 Use the **←/→ (cursor left/right)** buttons to select '**Rec Mode?**'.
- 3 Press **ENTER**.
- 4 Use the **↑/↓ (cursor up/down)** buttons to select '**R.Mode On**' or '**R.Mode Off**'.

Troubleshooting

Incorrect operations are often mistaken for trouble and malfunctions. If you think that there is something wrong with this component, check the points below. Sometimes the trouble may lie in another component. Investigate the other components and electrical appliances being used. If the trouble cannot be rectified even after exercising the checks listed below, ask your nearest Pioneer authorized service center or your dealer to carry out repair work.



Important

- If the system does not operate normally due to external effects such as static electricity disconnect the power plug from the outlet and insert again to return to normal operating conditions.

General

Problem	Remedy
The power does not turn on.	<ul style="list-style-type: none"> • Connect the power plug to the wall outlet. • Disconnect the power plug from the outlet, and insert again. • Make sure there are no loose strands of speaker wire touching the rear panel. This could cause the system to shut off automatically.
No sound is output when a function is selected.	<ul style="list-style-type: none"> • If you're using the line input, make sure the component is connected correctly (see <i>Connecting auxiliary components</i> on page 77). • Press MUTE on the remote control to turn muting off. • Adjust the VOLUME.
No image is output when playing discs.	<ul style="list-style-type: none"> • Make sure the TV is connected correctly (see <i>Connecting to your TV</i> on page 16). • Reset the video output to interlace (see <i>Connecting to your TV</i> on page 16).
No sound from surround or center speakers.	<ul style="list-style-type: none"> • Refer to <i>Setting the channel levels</i> on page 62 to check the speaker levels. • Check that you haven't selected the STEREO sound mode (see <i>Listening in stereo</i> on page 38). • Check that the Virtual Advanced Surround mode is not on (see <i>Using the Advanced Surround effects</i> on page 39). • Connect the speakers properly (see <i>Connecting the speakers</i> on page 13).

Problem	Remedy
Can't operate the remote control.	<ul style="list-style-type: none"> • Replace the batteries (see <i>Putting the batteries in the remote control</i> on page 9). • Operate within 23 ft. / 7 m, 30° of the remote sensor on the front panel (see <i>Using the remote control</i> on page 9). • Remove any obstacles or operate from another position. • Avoid exposing the remote sensor on the front panel to direct light.
Timer indicator is blinking and the system will not switch on.	<ul style="list-style-type: none"> • Unplug the system, then plug back in. Wait for one minute then switch on. • Make sure the fan at the rear of the system unit is not being blocked. • Check that the speakers are connected correctly. • Make sure the voltage of the mains power source is correct for the model. • If the problem persists, take it to your nearest Pioneer authorized service center or your dealer for servicing.

DVD/CD/Video CD player

Problem	Remedy
The disc is ejected automatically after loading.	<ul style="list-style-type: none"> • Clean the disc. • Align the disc properly in the disc guide. • If the region number on a DVD-video disc does not match the number on the system unit, the disc cannot be used (see <i>DVD Video regions</i> on page 74). • Allow time for any condensation inside the system unit to evaporate. Avoid using the system near an air-conditioning unit.
Playback is not possible.	<ul style="list-style-type: none"> • If the disc is loaded upside down, reload the disc with the label side face up.
Picture playback stops and the operation buttons cannot be used.	<ul style="list-style-type: none"> • Press ■ (stop), then ▶ (play) to start playback again. • Switch the power off once, then on again using the front panel ⏻ STANDBY/ON button.
Settings are canceled.	<ul style="list-style-type: none"> • When the power is cut due to power failure or by unplugging the power cable, settings will be canceled.
No picture/No color.	<ul style="list-style-type: none"> • Check that connections are correct and that plugs are inserted fully. • Check the instruction manual of the TV/monitor to make sure the TV/monitor settings are incorrect.
Screen is stretched or aspect does not change.	<ul style="list-style-type: none"> • The TV Screen setting is incorrect. Set the TV Screen option to match the TV/monitor you're using (see <i>TV Screen</i> on page 66).

Problem	Remedy
When recorded on a VCR or passed through an AV selector, there is disturbance in the playback picture.	<ul style="list-style-type: none"> This system uses copy-protection technology which may prevent recording or cause picture problems when connected through a VCR or AV selector. This is not a malfunction.
Picture disturbance during playback or dark.	<ul style="list-style-type: none"> This system is compatible with Macro-Vision System copy guard. Some discs include a copy prevention signal, and when this type of disc is played back, stripes etc., may appear on some sections of the picture depending on the TV. This is not a malfunction. Discs respond differently to particular system functions. This may result in the screen becoming black for a brief instant or shaking slightly when the function is executed. These problems are largely due to differences between discs and disc content and are not malfunctions of this system.
Noticeable difference in DVD and CD volume.	<ul style="list-style-type: none"> DVDs and CDs use different recording methods. This is not a malfunction.

WMA/MP3/JPEG discs

Problem	Remedy
CD-ROM disc is not recognized by the system.	<ul style="list-style-type: none"> Make sure that the CD-ROM was recorded using the ISO 9660 disc format. See <i>Disc / content format playback compatibility</i> on page 10 for other disc compatibility information.
Files don't show up in the Disc Navigator/Photo Browser.	<ul style="list-style-type: none"> The files on the disc must be named with the correct file extension: .mp3 for MP3 files; .wma for WMA files; .jpg for JPEG files (upper or lower-case is OK). See <i>Disc / content format playback compatibility</i> on page 10 for other disc compatibility information.
JPEG files appear, but MP3 and WMA files don't show up.	<ul style="list-style-type: none"> Set the PhotoViewer menu option in the Initial Settings menu to Off to be able to access the WMA/MP3 files. See <i>PhotoViewer</i> on page 72.

Tuner

Problem	Remedy
Auto tuning does not pick up some stations.	<ul style="list-style-type: none"> The radio signal is weak. Auto tuning will only detect radio stations with a good signal. For more sensitive tuning, connect an outdoor antenna.

Problem	Remedy
Sound is mono only.	<ul style="list-style-type: none"> • Check that the tuner is not set to FM mono (see <i>Improving poor FM reception</i> on page 35).
Considerable noise in radio broadcasts.	<ul style="list-style-type: none"> • Tune into the correct frequency. • Connect the antenna (see <i>Connecting the supplied antennas</i> on page 18 and <i>Connecting external antennas</i> on page 77). • Fully extend the FM wire antenna, position for best reception, and secure to a wall. • Connect an outdoor FM antenna (see <i>Connecting external antennas</i> on page 77). • Adjust the direction and position for best reception. • Connect an additional internal or external AM antenna (see <i>AM loop antenna</i> on page 18 and <i>Connecting external antennas</i> on page 77). • Turn off any other equipment that may be causing the noise or move it away from the system unit. • The tuning interval is incorrect for your country or region. Try switching the tuning interval (frequency step) (see <i>Changing the frequency step</i> on page 73).

Error Messages

Message	Description
Child Lock	<ul style="list-style-type: none"> • This message appears when the front panel buttons are pressed when the child lock feature is active. See <i>Child Lock</i> on page 73 for more on switching on/off the child lock.
Rec Mode On	<ul style="list-style-type: none"> • Blinks rapidly for 2 seconds when an operation is prohibited because the Recording Mode is on (see <i>Recording mode</i> on page 78).
Phones In	<ul style="list-style-type: none"> • Blinks rapidly for 2 seconds when an operation is prohibited because headphones are connected.
96K Stereo	<ul style="list-style-type: none"> • Blinks rapidly for 2 seconds when an operation is prohibited because the source is digital 88.2 or 96kHz PCM.
No Surr. SP	<ul style="list-style-type: none"> • Blinks rapidly for 2 seconds when an operation is prohibited because there is no surround speaker output.
Muting	<ul style="list-style-type: none"> • Blinks rapidly for 2 seconds when an operation is prohibited because the sound is muted (see <i>Muting the sound</i> on page 41).
Exit	<ul style="list-style-type: none"> • Appears briefly when a menu is automatically exited after a set period of inactivity.

Screen sizes and disc formats

DVD-Video discs come in several different screen aspects, ranging from TV programs, which are generally 4:3, to CinemaScope widescreen movies, with an aspect ratio of up to about 7:3.

Televisions also come in different aspect ratios; 'standard' 4:3 and widescreen 16:9.

Widescreen TV users

If you have a widescreen TV, the **TV Screen** setting (page 66) of this system should be set to **16:9 (Wide)**.

When you watch discs recorded in 4:3 format, you can use the TV controls to select how the picture is presented. Your TV may offer various zoom and stretch options; see the instructions that came with your TV for details.

Please note that some movie aspect ratios are wider than 16:9, so even though you have a widescreen TV, these discs will still play in a 'letterbox' style with black bars at the top and bottom of the screen.

Standard TV users

If you have a standard TV, the TV Screen setting (page 66) of this system should be set to **4:3 (Letter Box)** or **4:3 (Pan&Scan)**, depending on which you prefer.

Set to **4:3 (Letter Box)**, widescreen discs are shown with black bars top and bottom.



Set to **4:3 (Pan&Scan)**, widescreen discs are shown with the left and right sides cropped. Although the picture looks larger, you don't actually see the whole picture.



Please note that many widescreen discs override the system's settings so that the disc is shown in letterbox format regardless of the setting.



Tip

- Using the **16:9 (Wide)** setting with a standard 4:3 TV, or either of the 4:3 settings with a widescreen TV, will result in a distorted picture.

Selecting languages using the language code list

Some of the language options (such as 'DVD Language' in the Setup Navigator) allow you to set your preferred language from any of the 136 languages listed in the *Language code list* on page 84.

- Select 'Other Language'.**
- Use the ←/→ (cursor left/right) buttons to select either a code letter or a code number.**
- Use the ↑/↓ (cursor up/down) buttons to select a code letter or a code number.**

See *Language code list* on page 84 for a complete list of languages and codes.

Language code list

Language (Language code letter), **Language code**

Japanese (ja), 1001	Basque (eu), 0521	Lithuanian (lt), 1220	Samoan (sm), 1913
English (en), 0514	Persian (fa), 0601	Latvian (lv), 1222	Shona (sn), 1914
French (fr), 0618	Finnish (fi), 0609	Malagasy (mg), 1307	Somali (so), 1915
German (de), 0405	Fiji (fj), 0610	Maori (mi), 1309	Albanian (sq), 1917
Italian (it), 0920	Faroese (fo), 0615	Macedonian (mk), 1311	Serbian (sr), 1918
Spanish (es), 0519	Frisian (fy), 0625	Malayalam (ml), 1312	Siswati (ss), 1919
Dutch (nl), 1412	Irish (ga), 0701	Mongolian (mn), 1314	Sesotho (st), 1920
Russian (ru), 1821	Scots-Gaelic (gd), 0704	Moldavian (mo), 1315	Sundanese (su), 1921
Chinese (zh), 2608	Galician (gl), 0712	Marathi (mr), 1318	Swedish (sv), 1922
Korean (ko), 1115	Guarani (gn), 0714	Malay (ms), 1319	Swahili (sw), 1923
Greek (el), 0512	Gujarati (gu), 0721	Maltese (mt), 1320	Tamil (ta), 2001
Afar (aa), 0101	Hausa (ha), 0801	Burmese (my), 1325	Telugu (te), 2005
Abkhazian (ab), 0102	Hindi (hi), 0809	Nauru (na), 1401	Tajik (tg), 2007
Afrikaans (af), 0106	Croatian (hr), 0818	Nepali (ne), 1405	Thai (th), 2008
Amharic (am), 0113	Hungarian (hu), 0821	Norwegian (no), 1415	Tigrinya (ti), 2009
Arabic (ar), 0118	Armenian (hy), 0825	Occitan (oc), 1503	Turkmen (tk), 2011
Assamese (as), 0119	Interlingua (ia), 0901	Oromo (om), 1513	Tagalog (tl), 2012
Aymara (ay), 0125	Interlingue (ie), 0905	Oriya (or), 1518	Setswana (tn), 2014
Azerbaijani (az), 0126	Inupiak (ik), 0911	Panjabi (pa), 1601	Tonga (to), 2015
Bashkir (ba), 0201	Indonesian (in), 0914	Polish (pl), 1612	Turkish (tr), 2018
Byelorussian (be), 0205	Icelandic (is), 0919	Pashto, Pushto (ps), 1619	Tsonga (ts), 2019
Bulgarian (bg), 0207	Hebrew (iw), 0923	Portuguese (pt), 1620	Tatar (tt), 2020
Bihari (bh), 0208	Yiddish (ji), 1009	Quechua (qu), 1721	Twi (tw), 2023
Bislama (bi), 0209	Javanese (jw), 1023	Rhaeto-Romance (rm), 1813	Ukrainian (uk), 2111
Bengali (bn), 0214	Georgian (ka), 1101	Kirundi (rn), 1814	Urdu (ur), 2118
Tibetan (bo), 0215	Kazakh (kk), 1111	Romanian (ro), 1815	Uzbek (uz), 2126
Breton (br), 0218	Greenlandic (kl), 1112	Kinyarwanda (rw), 1823	Vietnamese (vi), 2209
Catalan (ca), 0301	Cambodian (km), 1113	Sanskrit (sa), 1901	Volapük (vo), 2215
Corsican (co), 0315	Kannada (kn), 1114	Sindhi (sd), 1904	Wolof (wo), 2315
Czech (cs), 0319	Kashmiri (ks), 1119	Sangho (sg), 1907	Xhosa (xh), 2408
Welsh (cy), 0325	Kurdish (ku), 1121	Serbo-Croatian (sh), 1908	Yoruba (yo), 2515
Danish (da), 0401	Kirghiz (ky), 1125	Sinhalese (si), 1909	Zulu (zu), 2621
Bhutani (dz), 0426	Latin (la), 1201	Slovak (sk), 1911	
Esperanto (eo), 0515	Lingala (ln), 1214	Slovenian (sl), 1912	
Estonian (et), 0520	Laothian (lo), 1215		

Country code list

Country, **Country code**, **Country code letter**

Argentina, 0118 , ar	France, 0618 , fr	Mexico, 1324 , mx	Spain, 0519 , es
Australia, 0121 , au	Germany, 0405 , de	Netherlands, 1412 , nl	Switzerland, 0308 , ch
Austria, 0120 , at	Hong Kong, 0811 , hk	New Zealand, 1426 , nz	Sweden, 1905 , se
Belgium, 0205 , be	India, 0914 , in	Norway, 1415 , no	Taiwan, 2023 , tw
Brazil, 0218 , br	Indonesia, 0904 , id	Pakistan, 1611 , pk	Thailand, 2008 , th
Canada, 0301 , ca	Italy, 0920 , it	Philippines, 1608 , ph	United Kingdom, 0702 , gb
Chile, 0312 , cl	Japan, 1016 , jp	Portugal, 1620 , pt	United States of America, 2119 , us
China, 0314 , cn	Korea, Republic of, 1118 , kr	Russian Federation, 1821 , ru	
Denmark, 0411 , dk	Malaysia, 1325 , my	Singapore, 1907 , sg	
Finland, 0609 , fi			

Glossary

Analog audio

An electrical signal that directly represents sound. Compare this to digital audio which can be an electrical signal, but is an indirect representation of sound. See also *Digital audio*.

Aspect ratio

The width of a TV screen relative to its height. Conventional TVs are 4:3 (in other words, the screen is almost square); widescreen models are 16:9 (the screen is almost twice as wide as it is high).

Digital audio

An indirect representation of sound by numbers. During recording, the sound is measured at discrete intervals (44,100 times a second for CD audio) by an analog-to-digital converter, generating a stream of numbers. On playback, a digital-to-analog converter generates an analog signal based on these numbers. See also Sampling frequency and *Analog audio*.

Dolby Digital / Pro Logic II



Dolby Digital uses up to 5.1 discrete channels of audio for surround sound. The front, center and surround channels are full range, while a Low Frequency Effects channel delivers bass sounds often used for sound effects (hence 5.1 channels).

Dolby Pro Logic II is a matrix decoding system that extracts 4.1 (Dolby Pro Logic) or 5.1 (Dolby Pro Logic II) channel surround sound from a two channel source.

DRM

DRM (Digital Rights Management) is a type of server software developed to enable secure distribution of paid content over the Web, recently incorporated by WMA (Windows Media Audio).

DTS



DTS stands for Digital Theater System. DTS is a surround system different from Dolby Digital that has become a popular surround sound format for movies.

Dynamic range

The difference between the quietest and loudest sounds possible in an audio signal (without distorting or getting lost in noise). Dolby Digital and DTS soundtracks are capable of a very wide dynamic range, delivering dramatic cinema-like effects.

EXIF (Exchangeable Image File)

A file format developed by Fuji Photo Film for digital still cameras. Digital cameras from various manufacturers use this compressed file format which carries date, time and thumbnail information, as well as the picture data.

File extension

A tag added to the end of a filename to indicate the type of file. For example, ".mp3" indicates an MP3 file.

ISO 9660

International standard for the volume and file structure of CD-ROM discs.

JPEG

A file format used for still images, such as photographs and illustrations. JPEG files are identified by the file extension “.jpg” or “.JPG”. Most digital cameras use this format.

MP3

MP3 (MPEG1 audio layer 3) is a compressed audio file format. Files are recognized by their file extension “.mp3” or “.MP3”.

MPEG audio

An audio format used on Video CDs and some DVD discs. This system can convert MPEG audio to PCM format for wider compatibility with digital recorders and AV amplifiers. See also *PCM*.

MPEG video

The video format used for Video CDs and DVDs. Video CD uses the older MPEG-1 standard, while DVD uses the newer and much better quality MPEG-2 standard.

PCM (Pulse Code Modulation)

The most common system of encoding digital audio, found on CDs and DAT. Excellent quality, but requires a lot of data compared to formats such as Dolby Digital and MPEG audio. See also *Digital audio*.

PBC (PlayBack Control) (Video CD only)

A system of navigating a Video CD through on-screen menus recorded onto the disc. Especially good for discs that you would normally not watch from beginning to end all at once—karaoke discs, for example.

Regions (DVD-Video only)

These associate discs and players with particular areas of the world. This system will only play discs that have compatible region codes. You can find the region code of your system by looking on the rear panel. Some discs are compatible with more than one region (or all regions).

Sampling frequency

The rate at which sound is measured to be turned into digital audio data. The higher the rate, the better the sound quality, but the more digital information is generated. Standard CD audio has a sampling frequency of 44.1kHz, which means 44,100 samples (measurements) per second. See also *Digital audio*.

WMA

WMA is short for Windows Media Audio and refers to an audio compression technology developed by Microsoft Corporation. WMA data can be encoded by using Windows Media Player version 8 or Windows Media Player for Windows XP. Files are recognized by their file extension “.wma” or “.WMA”.

Microsoft, Windows Media, and the Windows logo are trademarks, or registered trademarks of Microsoft Corporation in the United States and/or other countries.

Specifications

Amplifier section

Continuous Power Output (RMS):
 Front, center, surround75 W per channel
 (1 kHz, 10 % T.H.D., 6 Ω)
 Subwoofer75 W (100 Hz, 10 % T.H.D., 6 Ω)
 Continuous Power Output :
 Front, center, surround62 W per channel
 (1 kHz, 1 % T.H.D., 6 Ω)
 Subwoofer62 W (100 Hz, 1 % T.H.D., 6 Ω)

Disc section

Digital audio characteristics DVD fs: 96 kHz, 24-bit
 Type DVD system, video CD system and compact disc digital audio system
 Frequency response 4 Hz to 44 kHz
 Wow and Flutter Limit of measurement (±0.001 % W.PEAK) or less (JEITA)

FM tuner section

Frequency range 87.5 – 108 MHz
 Antenna 75 Ω, unbalanced

AM tuner section

Frequency range
 With 9 kHz step 531 kHz to 1,602 kHz
 With 10 kHz step 530 kHz to 1,700 kHz
 Antenna Loop antenna

Miscellaneous

Power requirements AC 120 V, 60 Hz
 Power consumption 175 W
 Power consumption in standby 0.39 W
 Dimensions420 (W) x 125 (H) x 448 (D) mm/
 16 ⁹/₁₆ (W) x 4 ¹⁵/₁₆ (H) x 17 ⁵/₈ (D) in.
 Weight9.8 kg / 21 lb. 10 oz

Accessories (DVD/CD receiver)

Remote control 1
 AA/R6P dry cell batteries 2
 Video cable (yellow plugs) 1
 AM loop antenna 1
 FM antenna 1
 Power cable 1
 Operating instructions 1
 Warranty Card 1

Speaker System

Front speakers

Enclosure Closed-box bookshelf type (magnetically shielded)
 System 2-way system
 Speakers
 Woofer 10 cm cone type
 Tweeter 5.2 cm cone type
 Nominal impedance 6 Ω
 Frequency range 60 Hz to 20 kHz
 Maximum Input Power 100 W
 Dimensions145 (W) x 235 (H) x 204 (D) mm
 5 ¹¹/₁₆ (W) x 9 ¹/₄ (H) x 8 ¹/₁₆ (D) in.
 Weight 2 kg / 4 lb 7 oz

Center speaker

Enclosure Closed-box bookshelf type (magnetically shielded)
 System 8.7 cm 1-way system
 Speakers 8.7 cm cone type
 Nominal impedance 6 Ω
 Frequency range 70 Hz to 20 kHz
 Maximum Input Power 100 W
 Dimensions310 (W) x 110 (H) x 85 (D) mm/
 12 ³/₁₆ (W) x 4 ⁵/₁₆ (H) x 3 ³/₈ (D) in.
 Weight 1 kg / 2 lb 3 oz

Surround speakers

Enclosure	Closed-box bookshelf type (magnetically shielded)
System8.7 cm 1-way system
Speakers8.7 cm cone type
Nominal impedance	6 Ω
Frequency range	90 Hz to 20 kHz
Maximum Input Power	100 W
Dimensions	110 (W) x 155 (H) x 82 (D) mm/ 4 ⁵ / ₁₆ (W) x 6 ¹ / ₈ (H) x 3 ¹ / ₄ (D) in.
Weight	0.8 kg / 1 lb 12 oz

Subwoofer

Enclosure	Bass-reflex floor type
System	16 cm 1-way system
Speaker	16 cm cone type
Nominal impedance	6 Ω
Frequency range	35 Hz to 2 kHz
Maximum Input Power	100 W
Dimensions	190 (W) x 360 (H) x 327 (D) mm/ 7 ¹ / ₂ (W) x 14 ³ / ₁₆ (H) x 12 ⁷ / ₈ (D) in.
Weight	5.0 kg / 11 lb 0 oz

Accessories (Speaker system)

Speaker cables6
non-skid pads	1 sheet

**Note**

- Specifications and design subject to possible modification without notice, due to improvements.

This product includes FontAvenue® fonts licenced by NEC corporation. FontAvenue is a registered trademark of NEC Corporation.



Dear Customer:

Selecting fine audio equipment such as the unit you've just purchased is only the start of your musical enjoyment. Now it's time to consider how you can maximize the fun and excitement your equipment offers. This manufacturer and the Electronic Industries Association's Consumer Electronics Group want you to get the most out of your equipment by playing it at a safe level. One that lets the sound come through loud and clear without annoying blaring or distortion—and, most importantly, without affecting your sensitive hearing.

Sound can be deceiving. Over time your hearing "comfort level" adapts to higher volumes of sound. So what sounds "normal" can actually be loud and harmful to your hearing. Guard against this by setting your equipment at a safe level BEFORE your hearing adapts.

To establish a safe level:

- Start your volume control at a low setting.
- Slowly increase the sound until you can hear it comfortably and clearly, and without distortion.

Once you have established a comfortable sound level:

- Set the dial and leave it there.

Taking a minute to do this now will help to prevent hearing damage or loss in the future. After all, we want you listening for a lifetime.

We Want You Listening For A Lifetime

Used wisely, your new sound equipment will provide a lifetime of fun and enjoyment. Since hearing damage from loud noise is often undetectable until it is too late, this manufacturer and the Electronic Industries Association's Consumer Electronics Group recommend you avoid prolonged exposure to excessive noise. This list of sound levels is included for your protection.

Decibel Level Example

30	Quiet library, soft whispers
40	Living room, refrigerator, bedroom away from traffic
50	Light traffic, normal conversation, quiet office
60	Air conditioner at 20 feet, sewing machine
70	Vacuum cleaner, hair dryer, noisy restaurant
80	Average city traffic, garbage disposals, alarm clock at two feet.

THE FOLLOWING NOISES CAN BE DANGEROUS UNDER CONSTANT EXPOSURE

90	Subway, motorcycle, truck traffic, lawn mower
100	Garbage truck, chain saw, pneumatic drill
120	Rock band concert in front of speakers, thunderclap
140	Gunshot blast, jet plane
180	Rocket launching pad

Information courtesy of the Deafness Research Foundation.



S001A_en

Should this product require service in the U.S.A. and you wish to locate the nearest Pioneer Authorized Independent Service Company, or if you wish to purchase replacement parts, operating instructions, service manuals, or accessories, please call the number shown below.

8 0 0 - 4 2 1 - 1 4 0 4

Please do not ship your product to Pioneer without first calling the Customer Support Division at the above listed number for assistance.

Pioneer Electronics (USA) Inc.
Customer Support Division
P.O. BOX 1760, Long Beach,
CA 90801-1760, U.S.A.

For warranty information please see the Limited Warranty sheet included with your product.

Should this product require service in Canada, please contact a Pioneer Canadian Authorized Dealer to locate the nearest Pioneer Authorized Service Company in Canada.

Alternatively, please contact the Customer Satisfaction Department at the following address:

Pioneer Electronics of Canada, Inc.
Customer Satisfaction Department
300 Allstate Parkway, Markham, Ontario L3R OP2
(905)479-4411
1(877)283-5901

For warranty information please see the Limited Warranty sheet included with your product.

Si ce produit doit être réparé au Canada, veuillez vous adresser à un distributeur autorisé Pioneer du Canada pour obtenir le nom du Centre de Service Autorisé Pioneer le plus près de chez-vous. Vous pouvez aussi contacter le Service à la clientèle de Pioneer:

Pioneer Electroniques du Canada, Inc.
Service à la clientèle
300, Allstate Parkway, Markham, Ontario L3R OP2
(905)479-4411
1(877)283-5901

Pour obtenir des renseignements sur la garantie, veuillez vous reporter au feuillet sur la garantie restreinte qui accompagne le produit.

S018D_enfr

PIONEER CORPORATION

4-1, Meguro 1-Chome, Meguro-ku, Tokyo 153-8654, Japan

PIONEER ELECTRONICS (USA) INC.

P.O. BOX 1540, Long Beach, California 90810-1540, U.S.A. TEL: (800) 421-1404

PIONEER ELECTRONICS OF CANADA, INC.

300 Allstate Parkway, Markham, Ontario L3R OP2, Canada TEL: (905) 479-4411

PIONEER EUROPE NV

Haven 1087, Keetberglaan 1, B-9120 Melsele, Belgium TEL: 03/570.05.11

PIONEER ELECTRONICS ASIACENTRE PTE. LTD.

253 Alexandra Road, #04-01, Singapore 159936 TEL: 656-472-1111

PIONEER ELECTRONICS AUSTRALIA PTY. LTD.

178-184 Boundary Road, Braeside, Victoria 3195, Australia, TEL: (03) 9586-6300

PIONEER ELECTRONICS DE MEXICO S.A. DE C.V.

Bldv.Manuel Avila Camacho 138 10 piso Col.Lomas de Chapultepec, Mexico,D.F. 11000 TEL: 55-9178-4270

K002E